

20247

Bench Swager



Try **Monster** - Buy **Monster** - Be **Monster**

Specification

Product Description

This hand operated bench swager and slip roller tool forms sheet metal up to 18 gauge thickness mild steel (or equivalent). Six sets of stand rollers are provided to allow large and small turning, burning, wiring, crimping and ogee beading.

It is easy to operate and is made from strong cast iron, ensuring minimum deflection of the workpiece. Mount it to your bench or work surface for extra stability whilst working (mounting hardware is not included).

Product Specifics

Capacity: 1.2mm / 18 GA

Throat depth: 457mm / 18"

Weight: 26KG

Monster Guarantee

If you wish to return a product in perfect working order, we provide a 30 day returns policy as long as the item is unopened and in a resalable condition.

A 12 month warranty applies to all of our electrical products; we will cover labour, parts and delivery charges. Our policy is to try and repair the item before arranging an exchange or refund.

If for any reason a part is missing please get in touch with us within 7 days on receipt of your order. You can contact our friendly and helpful Customer Support Team via email or call. For full terms and conditions contact our Support Department via the details on the Contact Us page.

Contact Us

Sales Department

For information regarding this device or other products from our Monster divisions please use the following details below.

Tel: 01347 878888

Email: hello@monstershop.co.uk

Support Department

For queries about this device, warranty, returns or reporting faults please use the following details below.

Tel: 01347 878887

Email: help@monstershop.co.uk

Website

To view our product range and fantastic offers in the Monster divisions please visit our website

www.monstershop.co.uk

Address

To visit our office Monster House and view our products, send postal correspondence or return items our address is provided below.

Monster House, Alan Farnaby Way, Sheriff Hutton
Industrial Estate, Sheriff Hutton, York YO60 6PG

Safety Advice

Safe Working Practice

Please read through the safe working practice to ensure prevention of injury or damage to the device.

Do not operate the device in areas of high temperature or humidity as the machine may not function correctly.

This product should only be used by a competent person who has read and understood this manual.

Do not modify this product in any way. Unauthorised modification may impair the function and/or safety and could decrease the life of the product.

If damaged, do not use.

Ensure the equipment is assembled securely before use.

Keep the working area clear from obstructions.

Wear appropriate clothing during use.

Do not exceed the capacities.

Do not use the product for applications other than which it was intended.

General cleaning and maintenance is required to prolong the working life of the product.

Do not use the tool where there is a risk of causing a fire or an explosion; e.g., in the presence of flammable liquids, gases, or dust. The tool can create sparks, which may ignite dust or fumes.

Do not allow the tool to come into contact with an electrical source. Contact will cause a shock.

Keep children and bystanders away from the work area while operating the tool. Do not allow children to handle the tool.

Safety Advice

Safety Working Practice

Do not use the tool while you are tired or under the influence of drugs, alcohol, or medication.

Do not wear loose clothing, dangling objects, or jewellery. Keep your hair, clothing and gloves away from moving parts. Loose clothes, jewellery, or long hair can be caught in moving parts.

Personal Protective Equipment (PPE) must be worn by the operator of this equipment.

Store the tool when it is not in use. Store it in a dry, secure place out of the reach of children. Inspect the tool for good working condition prior to storage and before re-use.

Use only accessories that are recommended by the manufacturer for use with your tool. Accessories that may be suitable for one tool may create a risk of injury when used with another.

Use on a sturdy and level work surface.

When mounting this product to a work surface, check that all mounting hardware are secure before commencing operation.

The slip roller and dies are coated at the factory with a protectant. To ensure proper fit and operation, remove the coating before first use. The coating is easily removed with a mild solvent, such as mineral spirits, and a soft cloth. Do not use lacquer thinner, paint thinner, or gasoline. These will damage painted surfaces.



Specification

Product Features

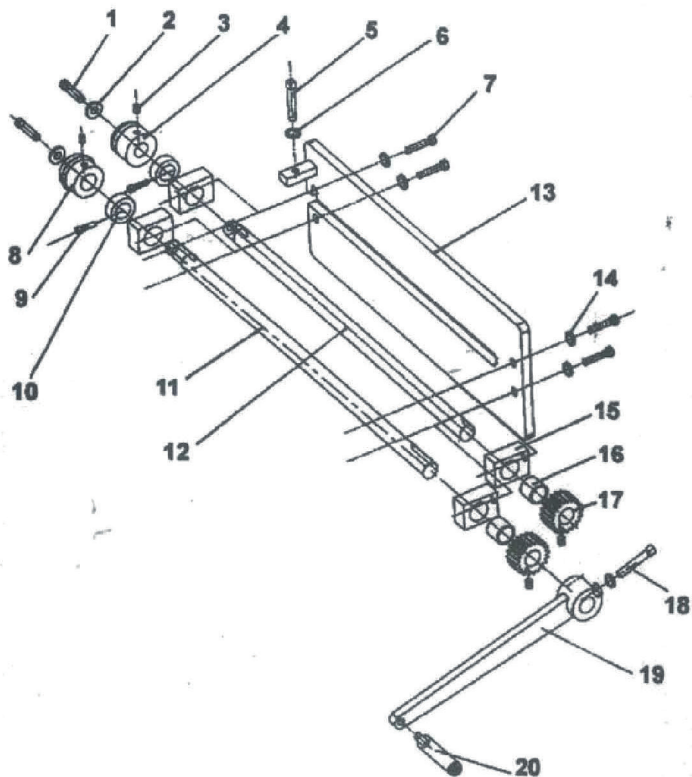

Specification

Product Features

Part No.	Description	Q'ty	Part No.	Description	Q'ty
1	Head screw M10	2	12	Driven shaft	1
2	Washer	2	13	Vertical bracket	1
3	Hex screw	4	14	Washer	4
4	Concave wheel	1	15	Supporting block	4
5	Screw	1	16	Copper bushing	2
6	Washer	2	17	Gear	2
7	Head screw M12	4	18	Square screw	1
8	Cam	1	19	Handle	1
9	Hex screw m6	2	20	Handle lever	1
10	Bushing	2	21	Roller die set	5
11	Main spindle	1			

User Guide

Before Each Use

The slip roller and dies are coated at the factory with a protector. To ensure proper fit and operation, remove the coating before first use. The coating is easily removed with a mild solvent, such as mineral spirits, and a soft cloth.

Periodically check the machine for wear or damaged parts and that it is debris-free to perform its function. Check that the rollers, especially the gears and crank handle, are not worn or damaged.

Check the condition of the roller and that its free of scraps or other debris and clean enough for operation.

Carefully move the machine to a well-lit area on a solid, level work bench, and secure to the bench with lag screws or bolts (not included). This location must allow access to all sides.

Rotate the handle and check whether the gears have good, firm contact with each other.

Verify that the roller is securely mounted to the workbench or surface.

Operating Instructions

1) Select the die set required for the next operation.

2) Place die set and retaining nuts onto the driving and driven shafts.

Tighten the retaining nuts with a wrench (not provided).

3) Adjust the position of the upper die according to thickness of the workpiece by using the screw (Part #5) on the top of the vertical bracket

User Guide

After Each Use

Clear away any scraps or debris to setup for the next operation.

The machine must be lubricated after operation with a few drops of oil.

Every thirty days of operation grease the gears

Lightly oil the rolls when not in use for a long period of time to prevent rust, just remember to remove this oil from the rollers when next used.

Maintenance

It is recommended that the general condition of any tool be examined before it is used.

Keep your tool in good repair by adopting a program of conscientious repair and maintenance in accordance with the recommended procedures found in this manual.

Keep the handles dry, clean, and free from oil and grease.

All exposed iron surfaces should be coated with light oil to prevent rusting.

Grease the gears monthly with a multi-purpose or bearing grease.



Monster Group (UK) is one of the UK's fastest growing online retailers. We supply a diverse range of products which offer exceptional value for money. We strive to provide the best possible customer experience with free UK delivery across all our products and a Monster Guarantee for 100% satisfaction.

Our dedicated customer service team will be more than happy to help with any questions you may have.

Home & Garden
Storage Shelving
Sign & Digital
Retail & Hospitality
Commercial Equipment

Check out all our Monster brands at www.monstershop.co.uk
