



20252

# Tube Notcher



Try **Monster** - Buy **Monster** - Be **Monster**

# Specification

## Product Description

This Tubing Notcher is great for assembling and welding tubing in your garage or workshop. Up to 45° angles can be adjusted in single degree increments. The notcher centres and aligns round tube automatically - 1/2in. and 5/8in. hole saw arbours can be accommodated too (hole saws are not included).

It is easy to operate and is made from strong cast iron. Mount it to a drill press table or strong work surface using the mounting plate - mounting hardware is not included.

## Product Specifics

Tubing Capacity: 2" Tubing

Required Drill Size: 1/2"

Spindle: 1/2"

Hole Saw Arbours: 1/2" and 5/8"

Weight: 5KG

## Monster Guarantee

If you wish to return a product in perfect working order, we provide a 14 day returns policy as long as the item is unopened and in a resalable condition.

A 12 month warranty applies to all of our electrical products; we will cover labour, parts and delivery charges. Our policy is to try and repair the item before arranging an exchange or refund.

If for any reason a part is missing please get in touch with us within 7 days on receipt of your order. You can contact our friendly and helpful Customer Support Team via email or call. For full terms and conditions contact our Support Department via the details on the Contact Us page.

# Contact Us

## Sales Department

For information regarding this device or other products from our Monster divisions please use the following details below.

Tel: 01347 878888

Email: [hello@monstershop.co.uk](mailto:hello@monstershop.co.uk)

## Support Department

For queries about this device, warranty, returns or reporting faults please use the following details below.

Tel: 01347 878887

Email: [help@monstershop.co.uk](mailto:help@monstershop.co.uk)

## Website

To view our product range and fantastic offers in the Monster divisions please visit our website

[www.monstershop.co.uk](http://www.monstershop.co.uk)

## Address

To visit our office Monster House and view our products, send postal correspondence or return items our address is provided below.

Monster House, Alan Farnaby Way, Sheriff Hutton  
Industrial Estate, Sheriff Hutton, York YO60 6PG

# Safety Advice

## Safe Working Practice

Please read through the safe working practice to ensure prevention of injury or damage to the device.

Do not operate the device in areas of high temperature or humidity as the machine may not function correctly.

This product should only be used by a competent person who has read and understood this manual.

Do not modify this product in any way. Unauthorised modification may impair the function and/or safety and could decrease the life of the product.

If damaged, do not use.

Ensure the equipment is assembled securely before use.

Keep the working area clear from obstructions.

Wear appropriate clothing during use.

Do not exceed the capacities.

Do not use the product for applications other than which it was intended.

General cleaning and maintenance is required to prolong the working life of the product.

Do not use the tool where there is a risk of causing a fire or an explosion; e.g., in the presence of flammable liquids, gases, or dust. The tool can create sparks, which may ignite dust or fumes.

Do not allow the tool to come into contact with an electrical source. Contact will cause a shock.

Keep children and bystanders away from the work area while operating the tool. Do not allow children to handle the tool.

# Safety Advice

## Safety Working Practice

Do not use the tool while you are tired or under the influence of drugs, alcohol, or medication.

Do not wear loose clothing, dangling objects, or jewellery. Keep your hair, clothing and gloves away from moving parts. Loose clothes, jewellery, or long hair can be caught in moving parts.

Personal Protective Equipment (PPE) must be worn by the operator of this equipment.

Store the tool when it is not in use. Store it in a dry, secure place out of the reach of children. Inspect the tool for good working condition prior to storage and before re-use.

Only use accessories that are recommended by the manufacturer for use with your tool. Accessories that may be suitable for one tool may create a risk of injury when used with another.

Only use this product on a sturdy and level work surface.

Check that the work piece is firmly clamped before each use. Carefully check that the tool will operate properly and perform its intended function.

Perform all “Before Use Checks” prior to using the product.

When mounting this product to a work surface, check that all mounting hardware are secure before commencing operation.



# Specification

## Product Features

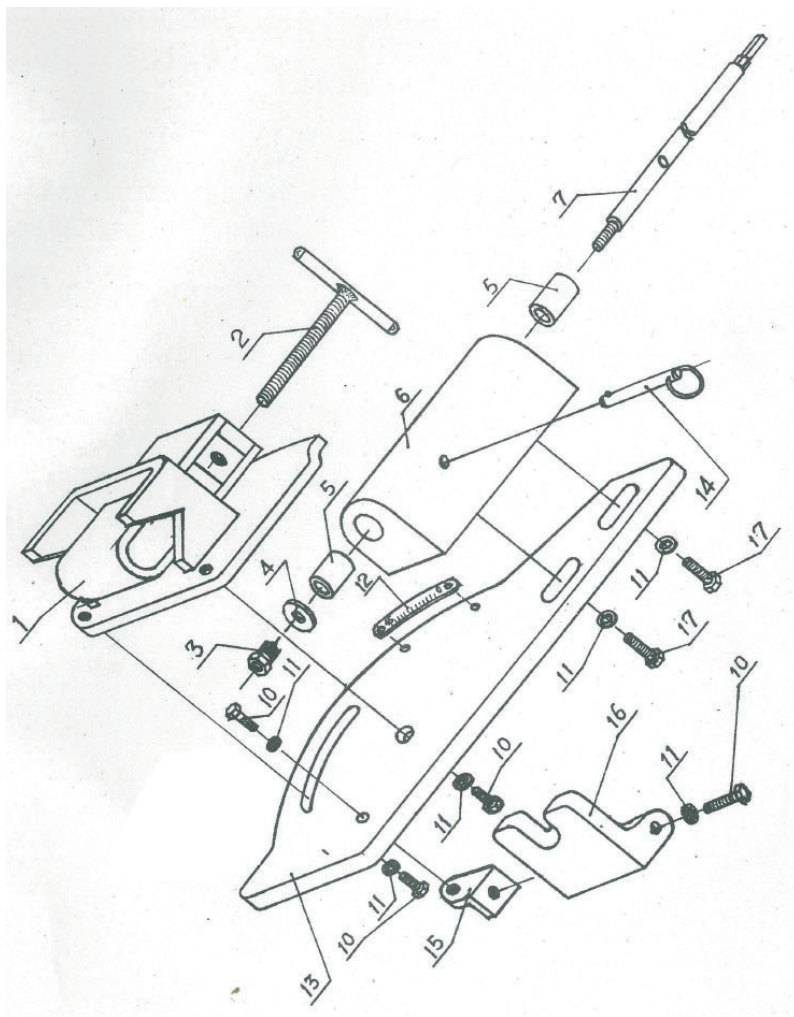

# Specification

## Product Features

Part No.	Description	Q'ty	Part No.	Description	Q'ty
1	Clamp Assembly	1	11	08 Washer	6
2	Handle/Clamp Screw	1	12	Angle Indicator	1
3	5/8" Hole Saw Adapter	1	13	Body	1
4	5/8" Hole Saw Adapter Washer	1	14	Locking Pin	1
5	Bushing	2	15	Adjustment Plate	1
6	Spindle Support	1	16	Mounting Plate	1
7	Spindle	1	17	M8x25 Bolt	2
10	M8x20 Bolt	4			

# User Guide

## Assembly

The tubing notcher must be mounted to a drill press table or strong workbench using the mounting plate (Part #16) - hardware is not included and can be purchased from most DIY stores.

The spindle (Part #7) will arrive in the reverse position to protect it during transit, please turn it around during installation.

After mounting, ensure that the spindle moves smoothly without binding against the bushings (Part #5).

## Before Each Use

Personal Protective Equipment (PPE) must be worn by the operator of this equipment.

Only use on sturdy, level surfaces.

Check that the workpiece is firmly clamped before use.

Check for damaged parts before each use. Carefully check that the tool will operate properly and perform its intended function.

Replace damaged or worn parts immediately. Never operate the tool with a damaged part.

Check that all mounting bolts are securely tightened before placing a workpiece in the notcher to prevent the notcher from unexpectedly shifting.



# User Guide

## Operating Instructions

1) Before placing a workpiece in the notcher, make sure that the spindle (Part #7) travels smoothly without binding against the bushings (Part #5). Any undue friction will cause premature wear.

Insert the workpiece tubing in the clamp assembly (1) underneath the inverted “V”. The inverted “V” feature of the clamp will hold your tubing (up to 2”) in place. Do not insert the tubing more than half way of its length.

2) The angle of the notcher can be adjusted by:

a) Loosening the left bolt (Part #10) that holds the clamp assembly to the adjustment plate (Part #15)

b) Rotating the assembly as necessary according to the angle indicator (Part #12)

c) Then re-tightening the left bolt.

3) For side-to-side adjustments:

a) Loosen the bolt (Part #10) that holds the adjustment plate (Part #15) to the mounting plate (Part #16).

When engaging in severe angles, only insert the tubing far enough so that you can start the cut. Secure the tubing in position using the handle/clamp screw (2).

Make sure the workpiece pipe is firmly clamped in place before notching to prevent it from suddenly shifting position during notching.

# User Guide

## Operating Instructions

When doing severe angle cuts with large diameter tubing you will need to put the spindle support (6) in its uppermost position in order to accommodate its size. However, you should always position the support as low as possible to preserve accuracy.

4) When installing a hole saw (not provided), check first to see if its arbour is 1/2" or 5/8". The threads on the spindle are for 1/2" hole saws, however, there is an adapter (Part #3) for 5/8" models that can be screwed on over the 1/2" threads.

You may need to use the adapter washer (Part #4) to ensure a good, secure fit.

**NOTE:** This notcher is designed for use only with threaded, metal cutting holes saws.

**DO NOT** use locking pliers or clamps to hold the spindle (Part #7) when higher speeds are required.

**NOTE:** Practice on different types of scrap tubing and at different angles before working with valuable or important tubing.

As you work, lubricate both the whole saw and the bushings with cutting oil to extend service life.

To move the spindle support, simply loosen the two bolts (17) that secure it to the body, reposition, and tighten the bolts.

Always secure the spindle with the locking pin (Part #14) by sliding the pin in through the hole on the side of the spindle support (Part #6) when the machine is not in use.

# User Guide

## After Each Use

After use in a run of same-type notches and tubes, clean up any excessive cutting oil or metal shavings to prepare for the next run.

If storing the notcher, follow these steps:

1. Clean up any cutting oil or metal shavings from the notcher.
2. Secure the spindle (7) with the locking pin (14) by sliding the pin in through the hole on the side of the spindle support (6).
3. Remove the notcher from the work surface, cover the notcher to protect it from dust.

## Maintenance

Keep your tool in good repair by adopting a program of conscientious repair and maintenance in accordance with the recommended procedures found in this manual.

Keep handles dry, clean, and free from oil and grease.



---

Monster Group (UK) is one of the UK's fastest growing online retailers. We supply a diverse range of products which offer exceptional value for money. We strive to provide the best possible customer experience with free UK delivery across all our products and a Monster Guarantee for 100% satisfaction.

Our dedicated customer service team will be more than happy to help with any questions you may have.

Home & Garden  
Storage Shelving  
Sign & Digital  
Retail & Hospitality  
Commercial Equipment

**Check out all our Monster brands at [www.monstershop.co.uk](http://www.monstershop.co.uk)**

---