



20253

English Wheel



Try **Monster** - Buy **Monster** - Be **Monster**

Specification

Product Description

This English Wheel is hand operated and will shape sheet steel and aluminium for automotive, motorcycle and aviation work.

The heavy duty frame ensures minimum deflection of the workpiece during forming operations whilst the anvil rack stores the included lower anvils: 2 inch, 3 inch, 4 inch, 6 inch, 8 inch and 12 inch radii.

We at Monster Group UK understand this is a new and exciting purchase, and although it is tempting to get stuck in please carefully read these instructions before you start using the machine.

Please refer to and read Safety Advice, Safe Working Practice to ensure prevention of injury or damage to the device before starting.

Product Specifics

Mild Steel Maximum Thickness: Up to 18 gauge (1.2mm)

Aluminium Maximum Thickness: Up to 14 gauge (1.5mm)

Throat depth: 560mm / 22"

Weight: 66KG

Monster Guarantee

If you wish to return a product in perfect working order, we provide a 30 day returns policy as long as the item is unopened and in a resalable condition.

A 12 month warranty applies to all of our electrical products; we will cover labour, parts and delivery charges. Our policy is to try and repair the item before arranging an exchange or refund.

If for any reason a part is missing please get in touch with us within 7 days on receipt of your order. You can contact our friendly and helpful Customer Support Team via email or call. For full terms and conditions contact our Support Department via the details on the Contact Us page.

Contact Us

Sales Department

For information regarding this device or other products from our Monster divisions please use the following details below.

Tel: 01347 878888

Email: hello@monstershop.co.uk

Support Department

For queries about this device, warranty, returns or reporting faults please use the following details below.

Tel: 01347 878887

Email: help@monstershop.co.uk

Website

To view our product range and fantastic offers in the Monster divisions please visit our website

www.monstershop.co.uk

Address

To visit our office Monster House and view our products, send postal correspondence or return items our address is provided below.

Monster House, Alan Farnaby Way, Sheriff Hutton
Industrial Estate, Sheriff Hutton, York YO60 6PG

Safety Advice

Safe Working Practice

Please read through the safe working practice to ensure prevention of injury or damage to the device.

Do not operate the device in areas of high temperature or humidity as the machine may not function correctly.

This product should only be used by a competent person who has read and understood this manual.

Do not modify this product in any way. Unauthorised modification may impair the function and/or safety and could decrease the life of the product.

If damaged, do not use.

Ensure the equipment is assembled securely before use.

Keep the working area clear from obstructions.

Wear appropriate clothing during use.

Do not exceed the capacities.

Do not use the product for applications other than which it was intended.

General cleaning and maintenance is required to prolong the working life of the product.

Do not use the tool where there is a risk of causing a fire or an explosion; e.g., in the presence of flammable liquids, gases, or dust. The tool can create sparks, which may ignite dust or fumes.

Do not allow the tool to come into contact with an electrical source. Contact will cause a shock.

Keep children and bystanders away from the work area while operating the tool. Do not allow children to handle the tool.

Safety Advice

Safety Working Practice

Do not use the tool while you are tired or under the influence of drugs, alcohol, or medication.

Do not wear loose clothing, dangling objects, or jewellery. Keep your hair, clothing and gloves away from moving parts. Loose clothes, jewellery, or long hair can be caught in moving parts.

Personal Protective Equipment (PPE) must be worn by the operator of this equipment.

Store the tool when it is not in use. Store it in a dry, secure place out of the reach of children. Inspect the tool for good working condition prior to storage and before re-use.

Only use accessories that are recommended by the manufacturer for use with your tool. Accessories that may be suitable for one tool may create a risk of injury when used with another.

Use on a sturdy and level work surface.



Specification

Product Features

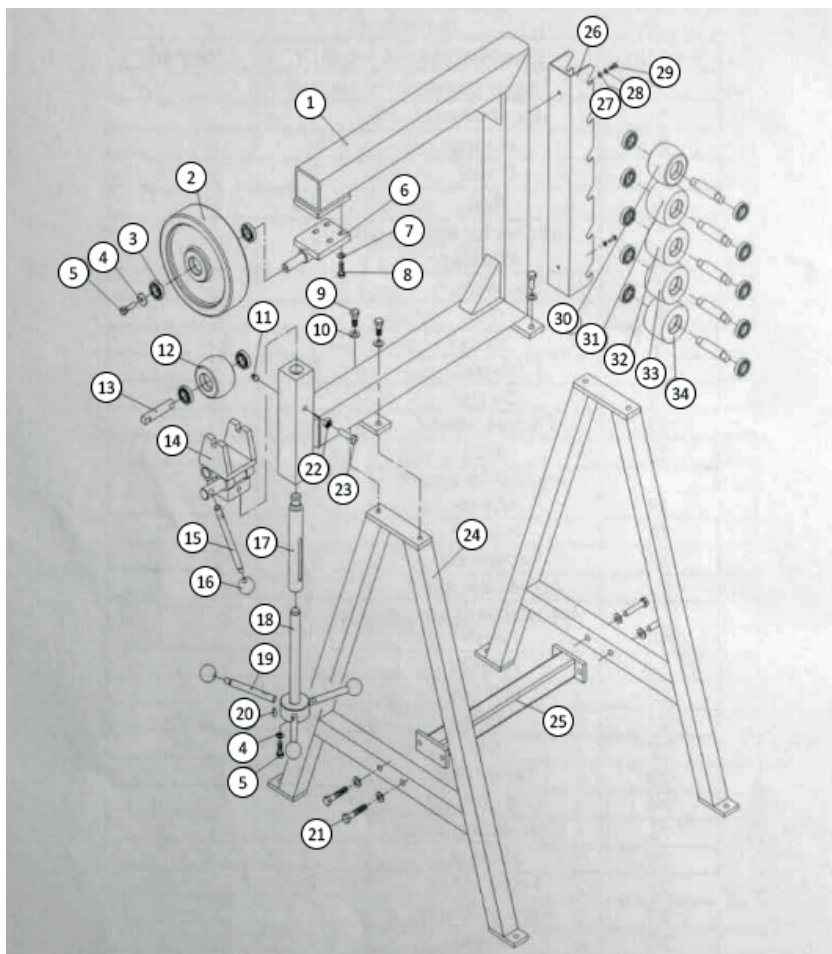

Specification

Product Features

1)	Upper Frame	Qty: 1
2)	Upper Anvil	Qty: 1
3)	Bearing	Qty: 14
4)	Washer	Qty: 2
5)	Bolt	Qty: 2
6)	Upper Anvil Bracket	Qty: 1
7)	Flat Washer	Qty: 4
8)	Bolt	Qty: 4
9)	Bolt	Qty: 4
10)	Washer	Qty: 8
11)	Oil Cup	Qty: 1
12)	2" Lower Anvil	Qty: 1
13)	Axle	Qty: 6
14)	Lower Anvil Bracket	Qty: 1
15)	Quick Release Lever	Qty: 1
16)	Lever Handle	Qty: 4
17)	Adjustable Shaft	Qty: 1
18)	Adjustable Threaded Shaft	Qty: 1
19)	Lower Anvil Tensioner	Qty: 1
20)	Flat Key	Qty: 1
21)	Bolt	Qty: 4
22)	Nut	Qty: 1
23)	Guide Bolt	Qty: 1
24)	Stand	Qty: 2
25)	Lower Support	Qty: 1
26)	Anvil Rack	Qty: 1
27)	Flat Washer	Qty: 2
28)	Spring Washer	Qty: 2
29)	Screw	Qty: 2
30)	3" Radius Lower Anvil	Qty: 1
31)	4" Radius Lower Anvil	Qty: 1
32)	6" Radius Lower Anvil	Qty: 1
33)	8" Radius Lower Anvil	Qty: 1
34)	12" Radius Lower Anvil	Qty: 1

User Guide

Assembly Instructions

The English Wheel should be assembled on a level surface in a well lit room. The area around the machine should be clear and free from scraps of metal, dirt and oil.

For specific part numbers please refer to the Product Features section when assembling this machine.

1) Using the bolts (Part #21) and washers (Part #10), secure the lower support (Part #25) to the stands (Part #24).

2) Attach the upper frame (Part #1) to the stand using bolts (Part #9) and washers (Part #10).

3) Insert one bearing (Part #3) into either side of the upper anvil (Part #2). Now connect the upper anvil bracket (Part #6) with the upper anvil using the bolt (Part #5) and washer (Part #4). Then the upper anvil and bracket is attached to the upper frame using the bolts (Part #8) and washers (Part #7).

4) Insert one bearing into either side of each other anvil 2" to 12" (Part #12, #30, #31, #32, #33, #34) and connect each with an axle (Part #13). These will be the lower anvils, select one of these anvils and it can be placed into the lower anvil bracket (Part #14).

5) The adjustable shaft (Part #17) should be secured into the upper frame as shown in the diagram using the guide bolt (Part #23) and nut (Part #22), the shaft should be able to move up and down but not rotate.

Insert the oil cup (Part #11) at the opposite side of the upper frame.

6) Insert the adjustable threaded shaft (Part #18) into the adjustable shaft as shown in the diagram and secure in place using the flat key (Part #20), with

User Guide

Assembly Instructions

the washer (Part #4) and bolt (Part #5).

Attach the three lower anvil tensioner handles (Part #16) to the base of the adjustable threaded shaft.

7) Connect the lower anvil bracket (Part #14) to the top of the adjustable shaft as it sits in the upper frame and secure in place with the quick release lever (Part #15) and its handle (Part #16).

8) Secure the anvil rack (Part #26) to the rear of the upper frame using the spring washers (Part #27), flat washers (Part #28) and screws (Part #29). The spare anvils can now be stored on the anvil rack.

9) The unpainted surfaces are coated with an oil to protect them from corrosion during shipping. Clean the workpiece and anvils thoroughly, making sure any abrasive particles or oily substances are removed.

Maintenance

It is recommended that the general condition of any tool be examined before it is used.

Keep your tool in good repair by adopting a program of conscientious repair and maintenance in accordance with the recommended procedures found in this manual.

Keep the handles dry, clean, and free from oil and grease.

Keep the anvils free from oil and dirt this can be pushed into the metal as it is shaped.

Top up the oil cup periodically to keep the machine working correctly, be careful not to fill with too much oil.

User Guide

Operation Instructions

The English Wheel stretches metal workpieces thinner and longer as they are rolled between the upper anvil and lower anvil.

- 1) Complete assembly using the Assembly Instructions.
- 2) If necessary dull any sharp edges with a de-burring tool (not provided) and always put on a pair of protective gloves.
- 3) Select the lower anvil required for your operation and place this chosen anvil onto the lower anvil bracket.
- 4) Adjust the position of the lower anvil using the lower anvil tensioner and the quick release lever, leaving approximately an inch between the upper and lower anvils.
- 5) Insert the workpiece between the anvils. Adjust the position of the lower anvil until the required pressure is applied to the workpiece, using the lower anvil tensioner and the quick release lever.
- 6) Roll the workpiece up to an edge, rotate it slightly, then pull it back. Repeat as you see fit, increasing and decreasing the pressure using the levers until the workpiece is processed to your requirements.
- 7) Insert the different lower anvils to achieve a variety of curves in the metal.



Monster Group (UK) is one of the UK's fastest growing online retailers. We supply a diverse range of products which offer exceptional value for money. We strive to provide the best possible customer experience with free UK delivery across all our products and a Monster Guarantee for 100% satisfaction.

Our dedicated customer service team will be more than happy to help with any questions you may have.

Home & Garden
Storage Shelving
Sign & Digital
Retail & Hospitality
Commercial Equipment

Check out all our Monster brands at www.monstershop.co.uk
