



Compressor Fridge 46.5L

210584/210585

INSTRUCTION MANUAL

www.monstershop.co.uk



SPECIFICATION

PRODUCT DESCRIPTION

The Compressor Fridge offers 42L of cool storage and an optional 4.5L of freezer space and has been specifically designed for caravans, camper trailers, boats and RV's. Store all your food and cold drinks whilst consuming a low amount of power with this built in fridge freezer.

PRODUCT SPECIFICS

DIMENSIONS:	380mm (W) x 530mm (H) x 490mm (D)
WEIGHT:	16.8kg
MATERIAL:	Stainless Steel/ VCM Metal & ABS Plastic
FRIDGE TEMPERATURE RANGE:	+5°C to +15°C
MINIMUM FREEZER TEMPERATURE:	-18°C
FRIDGE STORAGE VOLUME:	42L
FREEZER STORAGE VOLUME:	4.5L
RATED POWER:	40W
VOLTAGE:	DC 12/24V

ITEM CONTENTS

- 1 x Fridge
- 2 x Clear Plastic Drawer
- 1 x Wire Shelf
- 2 x Door Shelves
- 1 x Ice Cube Tray

SPECIFICATION

PRODUCT FEATURES

- A. Freezer Compartment
- B. LED Control Panel
- C. Wire Shelf
- D. Fruit / Salad Compartments
- E. Door Shelves
- F. Reversible Door



Monster Group UK Limited's liability will be limited to the commercial value of the product only.

SAFETY ADVICE

SAFE WORKING PRACTICE

Please read through the Safe Working Practice to ensure prevention of injury or damage to the device.

Ensure the instruction manual and safety advice have been read in full before installation and/or operating this fridge.

- Do not expose this fridge to sources of heat.
- If signs of excessive heat, fire or smoke become apparent, turn off the fridge fully, unplug it from the socket and arrange for repair. Do not use the fridge until it has been inspected by a qualified professional.
- Ensure the fridge has adequate ventilation; do not block ventilation holes.
- Do not use this fridge if the power cable is damaged.
- Do not operate this fridge with wet hands or clothes.
- Do not submerge this fridge in water. Do not allow this fridge to become excessively wet.
- Use this fridge on a flat, dry and even surface only.
- Maintenance and repairs should be carried out by a qualified technician. Do not attempt to repair the fridge yourself.
- Ensure fridge is fully switched off and disconnected from the power source before performing any maintenance.
- Do not use this fridge for anything other than its intended purpose.
- Always use the fridge the correct way up; do not put the fridge on its side.
- Inspect the fridge for signs of wear and damage before and after every use. If damage or significant wear is spotted, do not use fridge and arrange for repair.
- Before cleaning or servicing the fridge, switch off and unplug the fridge.
- Do not sit, stand or otherwise apply bodyweight to this fridge.
- Do not place any electrical devices inside the fridge.

USER GUIDE

INSTALLATION INSTRUCTIONS

Please note the following instructions for installation.

1. Install the fridge so that the warm air produced can easily flow away. (See diagram 1)
2. Keep objects clear of the openings in the housing or installation structure, such as ventilation slots.
3. Open the fridge door and remove the blanking plugs. (See diagram 2)
4. Install fridge into recess.
5. Place the blanking plugs back into the openings.

Diagram 1

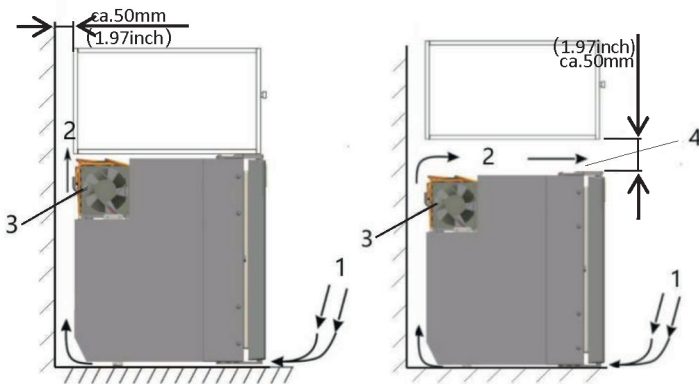

1. Cold Air
2. Hot Air
3. Compressor

USER GUIDE

INSTALLATION INSTRUCTIONS

Diagram 2

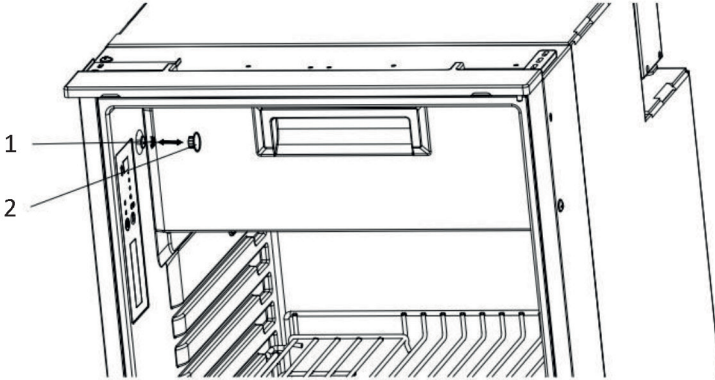

- 1. Plug Hole
- 2. Blanking Plug

SWAPPING THE DOOR HINGE

You can swap the hinge and lock so that its opens from the left. (See diagram 3)

Diagram 3

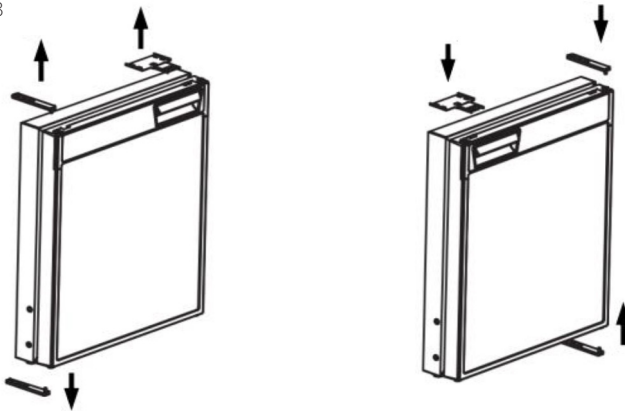

USER GUIDE

CONNECTING THE FRIDGE TO DC POWER SUPPLY

The fridge can be operated with 12 or 24V power supply.

For safety reasons, the refrigerator is equipped with an electronic system to prevent the polarity being reversed. This protects the refrigerator against reversed polarity when connecting to a battery and against short circuiting.

To protect the battery, the refrigerator switches off automatically if the voltage is insufficient (see table below).

	12V	24V
Cut-off voltage	10.4V	22.8V
Cut-in voltage	11.7V	24.2V

1. Connect the fridge to a plug socket which is fuse protected at 15A (12V) or 7.5A (24V)
2. Connect the red cable to the positive terminal of the battery.
3. Connect the black cable to the negative terminal of the battery.

PLEASE NOTE: Disconnect the fridge from the power supply before you charge your vehicle battery.

USER GUIDE

OPERATION INSTRUCTIONS

CONTROL PANEL

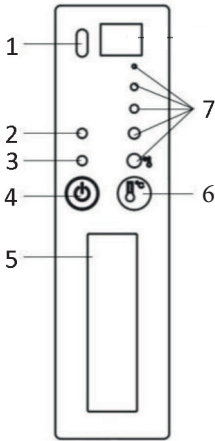

Button	Function
1	IR sensor for switching the interior light
2	LED Service display
3	LED Blue: Compressor is running Orange: Compressor is off
4	ON/OFF button
5	Interior Light
6	Temperature selection button
7	LED: Temperature levels

USER GUIDE

OPERATION INSTRUCTIONS

STARTING THE FRIDGE

Press the ON/OFF button. NOTE: The compressor will start up after a period of time.

SILENT MODE

Press and hold the ON/OFF button and the temperature selection button simultaneously. The Orange LED will flash 3 times. Repeat to turn off the silent mode. The LED will flash blue 3 times.

SETTING THE TEMPERATURE

Press the temperature selection button repeatedly until the desired temperature level is set. The lowest/largest LED is the coldest setting. The upper/smallest LED is the warming setting.

DEFROSTING THE FREEZER

Empty the fridge of all contents.
Press the ON/OFF button to turn off the fridge.
Close the fridge door.

MAINTENANCE

Always disconnect the fridge from the power supply before you clean or service it.

Clean the fridge regularly with a damp cloth.

Do not use abrasive cleaning agents or hard objects to clean the fridge.

Do not use hard or pointed tools to speed up the defrosting process.

TROUBLESHOOTING

RESOLUTION GUIDE

WHAT DO I DO IF THERE ARE MISSING PARTS FROM MY ORDER?

If there appears to be any part missing from your order, contact our friendly and helpful Customer Support Team within 7 days of receipt.

WHAT DO I DO IF THE FRIDGE ISNT COLD ENOUGH?

Check the temperature selection LED on the control panel and select a cooler setting if possible. If the fridge is already on the lowest setting then it may be the battery needs charging.

**FOR ALL OTHER ISSUES, PLEASE CONTACT OUR
CUSTOMER SUPPORT TEAM.**



SPÉCIFICATIONS

DESCRIPTION DU PRODUIT

DÉTAILS DU PRODUIT

LISTE DES PIÈCES

SPÉCIFICATIONS

CARACTÉRISTIQUES DU PRODUIT

La responsabilité de Monster Group UK Limited sera limitée à la valeur commerciale du produit.

CONSEILS DE SÉCURITÉ

 PRATIQUE DE TRAVAIL SÉCURITAIRE

MODE D'EMPLOI

INSTRUCTIONS DE MONTAGE

MODE D'EMPLOI

ENTRETIEN

DÉPANNAGE

GUIDE DE RÉOLUTION

QUE FAIRE S'IL MANQUE DES PIÈCES À MA COMMANDE?

S'il semble manquer des pièces à votre commande, contactez notre équipe du service client dans les 7 jours suivant la réception.

**POUR TOUT AUTRE PROBLÈME, VEUILLEZ
CONTACTER NOTRE ÉQUIPE DU SERVICE CLIENT.**



SPEZIFIKATIONEN

PRODUKTBESCHREIBUNG

PRODUKTSPEZIFIKA

TEILELISTE

SPEZIFIKATION

PRODUKTMERKMALE

Die Haftung von Monster Group UK Limited ist auf den Handelswert des Produkts beschränkt.

SICHERHEITSHINWEIS

 SICHERES ARBEITEN

BENUTZERLEITFADEN

MONTAGEANLEITUNGEN

BENUTZERLEITFADEN

WARTUNG

FEHLERBEHEBUNG

LÖSUNGSGUIDE

WAS MACHE ICH, WENN BEI MEINER BESTELLUNG TEILE FEHLEN?

Falls bei Ihrer Bestellung ein Teil zu fehlen scheint, wenden Sie sich bitte innerhalb von 7 Tagen nach Erhalt der Ware an unser freundliches und hilfsbereites Kundenservice-Team.

**FÜR ALLE ANDEREN FRAGEN WENDEN SIE SICH BITTE AN
UNSER KUNDENSERVICE-TEAM.**



ESPECIFICACIONES

DESCRIPCIÓN DEL PRODUCTO

ESPECIFICACIONES DEL PRODUCTO

LISTA DE PIEZAS

ESPECIFICACIONES

CARACTERÍSTICAS DEL PRODUCTO

La responsabilidad de Monster Group UK Limited estará limitada únicamente al valor comercial del producto.

CONSEJOS DE SEGURIDAD

PRÁCTICAS DE TRABAJO SEGURAS

GUÍA DEL USUARIO

INSTRUCCIONES DE ENSAMBLAJE

GUÍA DEL USUARIO

MANTENIMIENTO

SOLUCIÓN DE PROBLEMAS

GUÍA DE RESOLUCIÓN

¿QUÉ PUEDO HACER SI LE FALTAN PIEZAS A MI PEDIDO?

Si parece faltar alguna pieza en su pedido, por favor, comuníquese con nuestro amable y servicial Equipo de Atención al Cliente en los 7 días posteriores a la recepción de su pedido.

**PARA CUALQUIER OTRO PROBLEMA, POR FAVOR CONTACTE
CON NUESTRO EQUIPO DE ATENCIÓN AL CLIENTE**



SPECIFICHE

DESCRIZIONE DEL PRODOTTO

SPECIFICHE DEL PRODOTTO

LISTA COMPONENTI

SPECIFICHE

CARATTERISTICHE DEL PRODOTTO

La responsabilità di Monster Group UK Limited sarà limitata al solo valore commerciale del prodotto.

CONSIGLI PER LA SICUREZZA

 PRATICHE DI LAVORO SICURO

GUIDA UTENTE

ISTRUZIONI PER IL MONTAGGIO

GUÍA DEL USUARIO

MANTENIMIENTO

RISOLUZIONE DEI PROBLEMI

GUIDA ALLA RISOLUZIONE DEI PROBLEMI

COSA DEVO FARE SE NEL MIO ORDINE CI SONO DELLE PARTI MANCANTI?

Se sembra che all'interno del tuo ordine manchino delle parti, contatta il nostro gentile e disponibile team di assistenza clienti entro 7 giorni dalla ricezione del tuo ordine.

**PER QUALUNQUE ALTRO PROBLEMA, CONTATTA IL NOSTRO
TEAM DI ASSISTENZA CLIENTI.**



OMSCHRIJVING

PRODUCT OMSCHRIJVING

PRODUCTSPECIFICATIES

ONDERDELENLIJST

SPECIFICATIE

PRODUCT SPECIFICATIE

De aansprakelijkheid van Monster Group UK Limited is beperkt tot de commerciële waarde van het product.

VEILIGHEIDSADVIIES

 VEILIG GEBRUIK

HANDLEIDING

MONTAGE-INSTRUCTIES

HANDLEIDING

ONDERHOUD

PROBLEEM OPLOSSEN

OPLOSSINGEN

WAT MOET IK DOEN ALS ER ONDERDELEN VAN MIJN BESTELLING ONTBREKEN?

Neem wanneer een onderdeel van je bestelling ontbreekt binnen 7 dagen na ontvangst contact op met onze vriendelijke en behulpzame klantenservice.

**NEEM VOOR ALLE ANDERE KWESTIES CONTACT
MET ONZE KLANTENSERVICE OP.**



SPECIFIKATION

PRODUKTBESKRIVNING

PRODUKTSPECIFIKATIONER

MEDFÖLJANDE DELAR

SPECIFIKATION

PRODUKTFUNKTIONER

SÄKERHETSÅD

 SÄKER ARBETSÖVNING

ANVÄNDARGUIDE

MONTERINGS INSTRUKTIONER

BRUKSANVISNING

SKÖTSEL

FELSÖKNING

LÖSNINGSGUIDE

VAD GÖR JAG OM DET SAKNAS DELAR FRÅN MIN BESTÄLLNING?

Om det verkar som om någon del saknas i din beställning, kontakta vårt vänliga och hjälpsamma kundsupportteam inom 7 dagar efter mottagandet.

**FÖR ALLA ANDRA FRÅGOR, VÄNLIGEN KONTAKTA VÅRT
KUNDSUPPORTTEAM.**

Monster Group (UK) is one of the UK's fastest growing online retailers. We supply a diverse range of products which offer exceptional value for money. We strive to provide the best possible customer experience with free UK delivery across all our products and a Monster Guarantee for 100% satisfaction.

For information regarding this device or other products from our Monster divisions please contact Sales.

SALES

TEL: 01347 878 888

EMAIL: hello@monstershop.co.uk

For queries about this device, warranty, returns or reporting faults please contact Support.

SUPPORT

TEL: 01347 878 887

EMAIL: help@monstershop.co.uk

Pour plus d'informations concernant cet appareil ou d'autres produits de nos divisions de Monster veuillez utiliser les détails suivants ci-dessous.

DÉPARTEMENT COMMERCIAL

TEL: 01347 878 888

EMAIL: bonjour@monstershop.eu

Pour les interrogations concernant cet appareil, la garantie, les retours ou les défauts de déclaration veuillez utiliser les détails suivants ci-dessous.

DÉPARTEMENT DE SOUTIEN

TEL: 01347 878 887

EMAIL: help@monstershop.co.uk

Para información sobre este dispositivo u otros productos de nuestras divisiones de Monster por favor use los siguientes detalles.

DEPARTAMENTO DE VENTAS

TEL: 01347 878 888

EMAIL: hola@monstershop.eu

Para consultas sobre este dispositivo, la garantía, devoluciones o denuncias de fallos por favor use los siguientes detalles.

DEPARTAMENTO DE SOPORTE

TEL: 01347 878 887

EMAIL: help@monstershop.co.uk

Für Informationen bezüglich dieses Geräts oder anderer Produkte aus unserer Monster-Abteilung, benutzen sie die folgenden unten aufgeführten Angaben.

VERKAUFABTEILUNG

TEL: 01347 878 888

EMAIL: hallo@monstershop.eu

Für Fragen über dieses Gerät, die Garantie, Rückgaben oder bei Störungen, benutzen sie die folgenden unten aufgeführten Angaben.

SUPPORT-ABTEILUNG

TEL: 01347 878 887

EMAIL: help@monstershop.co.uk

Per informazioni riguardanti questo dispositivo o altri prodotti dalle categorie Monster utilizzare i dettagli sotto riportati.

DIPARTIMENTO VENDITE

TEL: 01347 878 888

EMAIL: ciao@monstershop.eu

Per domande riguardo dispositivo, garanzia, reso o per riferire di guasti, utilizzare i dettagli sotto riportati.

DIPARTIMENTO SUPPORTO

TEL: 01347 878 887

EMAIL: help@monstershop.co.uk

Monster House, Alan Farnaby Way,
Sheriff Hutton Industrial Estate,
Sheriff Hutton, York, YO60 6PG
www.monstershop.co.uk



 Try **Monster**. Buy **Monster**. Be **Monster**. 