



**24305**

# T-Mech Stump Grinder



Try **Monster** - Buy **Monster** - Be **Monster**

# Specification

## Product Description

Thank you for purchasing this 13HP T-Mech Stump Grinder. There's nothing more laborious than removing roots and stumps. Taking down a tree can be troublesome, but it's usually the roots and stump that are much more difficult to clear. Time-consuming and requiring raw strength, it's never a simple or exciting task. Enter the T-Mech Stump Grinder!

The Stump Grinder is perfect for professionals or dedicated amateurs. Its nine-piece tungsten blade cutting head action makes light work of tough stumps, shredding through roots with pure force. This heavy duty machine features grab bars designed to allow transportation for expert gardeners and landscapers. In no time, you can finally look forward to grinding away those frustrating stumps and roots with precision and ease.

This product comes with Personal Protective Equipment that must be used during operation. An emergency shut down handle and front-ended cutting head provides maximum safety during operation.

We at Monster Group UK understand this is a new and exciting purchase, and although it is tempting to get stuck in please carefully read these instructions before you start using the machine.

**NOTE: The T-Mech Stump Grinder is designed to be used by a competent person. It should not be used by inexperienced operators unless accompanied by an experienced operator. The open cutting head of this tool brings a Danger Zone immediately in front of the machine when in operation which should not be ignored. Do not expose this machine to wet conditions, do not use under poor lighting, and wear Personal Protective Equipment at all times.**

**Please refer to and read Safety Advice, Safe Working Practice to ensure prevention of injury or damage to the machine before starting.**

# Specification

## Item Contents

2 x Wheels  
6 x Nylon anti-loose Nuts  
10 x Flat Washers  
6 x Spring Washers  
6 x Angle Bolts  
1 x Grab Bars  
1 x Handle Bars  
1 x Adjustable Handle Lever  
1 x Handle Bolt  
1 x Safety Equipment incl. Ear Muffs, Safety Goggles, and Safety Gloves  
1 x Tool Kit for Assembly and Maintenance

## Technical Information

Engine: 13HP 4-stroke engine  
Fuel Volume: 6.5 litre  
Oil Volume: 1.1 litre  
Starting system: Recoil  
Quantity of teeth: 9 pcs tungsten blades  
Wheel Diameter: 300mm  
Wheel Width: 90mm  
Cut Depth: 225mm below ground, 515mm above ground  
Belt: Two piece V-belt  
Brake: Drum Brake

## Product Specifics

Dimensions: (H x W x D) 158cm x 70cm x 120cm  
Weight: 110KG

# Specification

## Monster Guarantee

If you wish to return a product in perfect working order, we provide a 30 day returns policy as long as the item is unopened and in a resalable condition.

A 12 month warranty applies to all of our electrical products; we will cover the cost of labour and parts. Our policy is to try and repair the item before arranging an exchange or refund.

If for any reason a part is missing please get in touch with us within 7 days on receipt of your order. You can contact our friendly and helpful Customer Support Team via email or call. For full terms and conditions contact our Support Department via the details on the Contact Us page.

# Safety Advice

## Safe Working Practice

**Please read through the safe working practice to ensure prevention of injury or damage to the machine.**

Those under the age of 16 must not operate this machine, even if accompanied by an experienced or trained adult.

When running, the machine should never be left unsupervised. An experienced or trained individual must always be in control of the machine when the engine is in operation.

In case of entanglement, it is strongly advised to always work with an accompanying adult who is also trained to use this machine.

Before starting the engine, please ensure there are no children or pets/ animals in the vicinity. Other than experienced and trained users, no individual or animal should be within 10 metres from the machine when the engine is running.

Personal Protective Equipment (PPE) must be worn by the operator(s) of this equipment.

Ensure that the correct footwear--non-slip safety boots--is worn at all times, and always work to the side of the machine, never in front.

Under no circumstance should you operate the machine without heavy duty clothing, nor should it be operated whilst wearing jewellery or where hair is draping or hanging.



# Safety Advice

## Safe Working Practice

It is strongly advised to check the material in the vicinity before starting the process to avoid causing hazardous dusts and debris. Wear a face mask where appropriate to avoid inhalation of dust and other substances.

The sheer power of this machine may cause wood chippings to eject from its base at great force; remember, always wear PPE to avoid personal injury.

Do not operate this machine whilst under the influence of drugs, alcohol or medication.

When operating on a slope, exercise extreme caution as the machine may move unpredictably.

Never operate uphill or downhill and always grind stumps from the side.

Do not attempt to cut on a slope of more than 15 degrees.

This machine is very heavy and safe precautions must be taken when moving and transporting the machine. Ensure you can safely manage the machine before attempting to operate. When transporting, enlist a team of people to correctly and safely transport. The machine must be tied down in transit. You can find more information regarding the transportation of the machine further on in this manual.

You should also be wary that the machine may move unpredictably due to the nature of the task at hand.

As set out further on in this manual, take extreme care when dealing with oil and petrol as these are highly flammable.



# Safety Advice

## Safe Working Practice

Store all fluid and oil in containers specifically designed and approved for this purpose. Keep these away from heat, open flames, and out of reach of children.

Filling and re-filling of the engine should be conducted outdoors with the engine off. The engine should be given ample time to cool if it has been in use recently.

Do not attempt to handle petrol when smoking, or when somebody in the vicinity is smoking. This could cause the fuel to ignite or explode.

Use extreme caution when handling fuel. In case of spillage, do not start the engine. Move the machine away from the spillage to avoid creating any source of ignition. Wipe up the fuel and allow time for all vapours or fumes to dissipate fully. Dispose of the waste properly to prevent fire hazards.

If working near a road, ensure you are wearing high-visibility workwear and you are fully aware of the flow of traffic when operating.



# Specification

## Product Features



- 1) Rectangular Handle Bars to improve control of the machine.
- 2) Throttle.
- 3) Adjustable Handle to further help with handling.
- 4) Fuel Tank.
- 5) Riveted, high-grip Wheels.
- 6) Nine-pronged Cutting Head made from tungsten blades which make light work of difficult roots and stumps.
- 7) Brake.



# User Guide

## Assembly Instructions

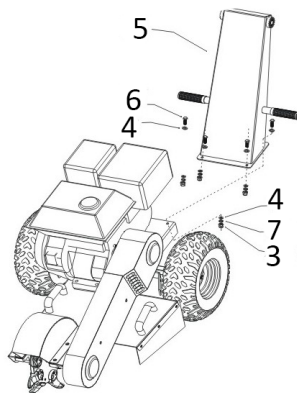
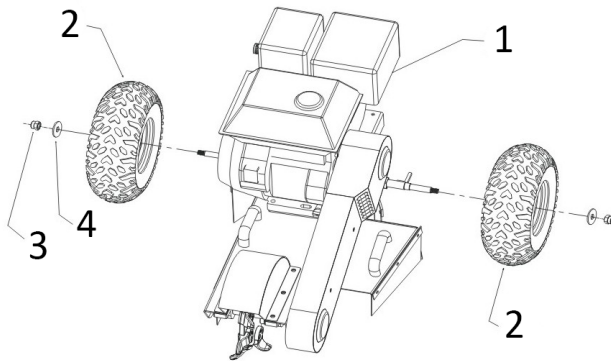

# User Guide

## Assembly Instructions

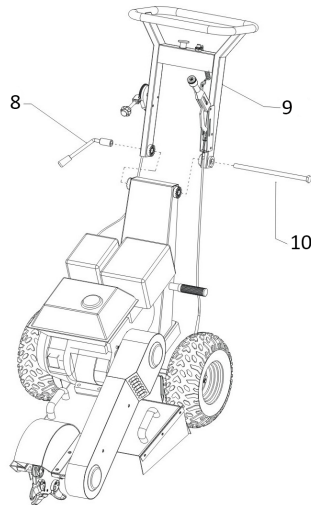

### Assembly Parts;

1	Engine
2	Wheel
3	Nut
4	Flat Washer
5	Grab Bars
6	Angle Bolt
7	Spring Washer
8	Adjustable Handle Lever
9	Handle Bars
10	Handle Bolt

# User Guide

## Assembly Instructions

**The assembly of this machine requires a minimum of two persons. Ideally, 3 or more people should assist you in the safe and proper assembly.**

1) On the wheel axle, detach the bolt and washer. Pivot the machine to the left so that the right wheel can be fitted. Tighten using the washer and bolt with the spanner provided.

2) Before attaching the left wheel, you must attach the brake cable to the brake disc. Thread the brake cable through the catch on the brake disc, as in the pictures below.

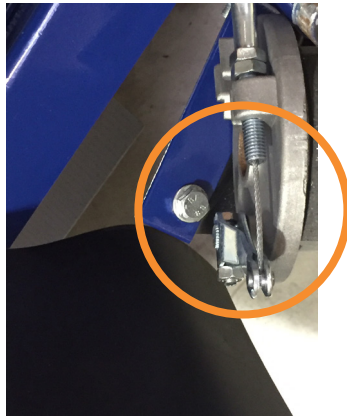
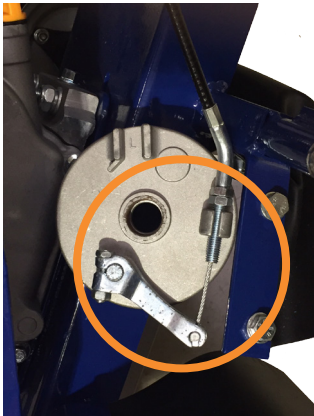

NOTE: If you are struggling to connect the brake cable to the brake disc, you may need to slacken the brake. On the brake lever, unscrew the connecting bolt to loosen the cable so it will reach. See the picture below. Follow the next steps to attach the wheel BEFORE re-tightening this bolt.

**WARNING: Do not attempt to move the machine having not inflated the tyres to the appropriate PSI. Once you have fitted the wheels, inflate before moving on to the next step.**



# User Guide

## Assembly Instructions

3) Once fitted, place the Disc Brake onto the axle. Notice how the disc brake slots into place in the picture below.

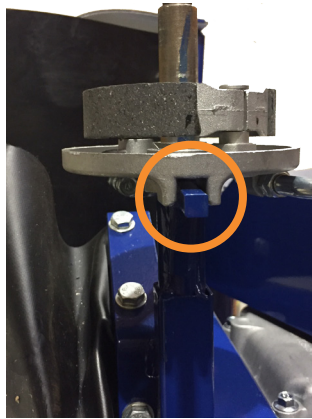

4) Now fit the left wheel onto the axle. Pivot until the axle protrudes from the wheel bearing and use a Nut (3) and Flat Washer (4) to attach, tightening firmly with the spanner provided.

5) Attach the Grab Bars (5) to the base using 4 x Angle Bolts (6) and Nuts (3). Remember to use Flat Washers (4) and Spring Washers (7) to fit safely. See the pictures below.

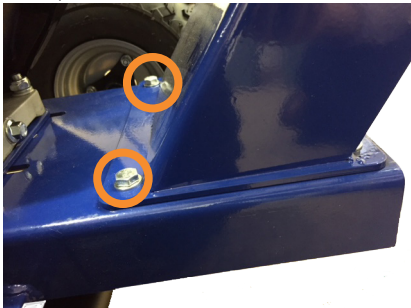

# User Guide

## Assembly Instructions

6) Attach the Handle Bars (9) by removing the Handle Bolt (10) and Handle Lever (8). Align the teeth, then use the Handle Lever (8) to tighten firmly. When attaching, take consideration of the cables. Ensure they do not prevent movement or restrict safe action of the machine. See the images below.



7) Notice the lead out cable that runs from the Emergency Stop switch. At the end of this cable are two wires; one red, one black. The red wire needs to be connected to the plastic cap next to the ON/OFF switch. The black wire is for grounding, and **MUST** be placed beneath a nut. Unscrew slightly a nut located around the engine, carefully place the grounding wire underneath the nut, and tighten firmly. See the images below.

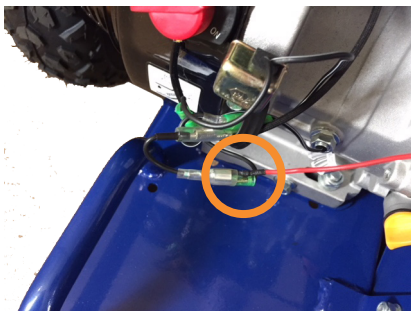

# User Guide

## Assembly Instructions

8) Check that all nuts and bolts are fitted firmly and properly. Engage the brake to check that it is working. Notice that the brake only operates the left wheel, the right wheel should move freely.

## Before First Use

**To reiterate the point previously made in this manual, this machine should only be operated by properly instructed and responsible persons. Inexperienced users should be supervised by experienced individuals. It is strongly advised you work alongside another trained person when operating the machine.**

After assembly, ensure once more that all bolts are firmly fitted and no nuts are loose or frayed.

## First Fuelling

**The Stump Grinder requires both oil and unleaded petrol to operate and for safety precautions comes without these.**

Below, you can find which type of oil and petrol that must be used;

Oil: 10w-30 / 10w-40 / 15w-30 / 15w-40 non-synthetic (mineral) engine oil.

Petrol: Unleaded petrol. Remember: the Fuel Volume is 6.5 litres, the Oil Volume is 1.1 litres.

# User Guide

**WARNING:** Attempting to operate the machine without the correct oil and petrol could damage the machine irreparably and will void your warranty. When adding oil and petrol, always ensure the engine is switched off, the machine is cold, and there are no obstructions within the vicinity.

Remove the Dipstick from the engine and fill slowly with the correct oil. Take care not to overfill and check the level with the Dipstick. Replace the Dipstick when filled. Now remove the Fuel Tank Cap and fill with petrol. Do not fill any further than 15mm below the roof of the tank. Again, pour slowly and take care not to overfill. If a spillage occurs, do not operate the machine. Clean the spillage immediately and allow the fumes to dissipate before proceeding.

## Starting the Engine

**Ensure there are no children or pets within 10 metres of the machine, and ensure that any children and/or pets in your surroundings are kept under the watchful eye of a responsible adult.**

- 1) Equip your Personal Protective Equipment
- 2) Engage the Brake by pulling the Brake Lever back fully.
- 3) Ensure that the Throttle is in a slow position for start-up.
- 4) If the engine is cold, move the Choke Lever towards the Closed position.
- 5) Raise the Cutter Head wheel 4 to 5 inches from the ground by pushing down on the Handle Bar and pivot the machine into this position.
- 6) Pull the Starter Cord until you feel resistance, then pull sharply. Allow the Starter Cord to recoil back by hand.
- 7) Now push the Choke to Open position. If the engine is cold, allow the machine to sit idly (with the Throttle in the slow position) until it warms up.
- 6) When engaging the throttle, the Cutter Head wheel will begin to rotate. You are now ready to commence grinding. Read on for how to efficiently tackle the stumps.

# User Guide

## Before You Begin

Before you begin, you should ensure that all loose pieces of wood, stones, wire, and other debris are cleared from the area; the clearer the stump area, the more efficient the stump removal will be.

Consider wind direction. This will impact in which way the wood chippings, dust and other stump debris will blow during the operation.

Do not attempt to operate the Stump Grinder during low visibility such as darkness, fog, or mist. Adequate lighting is imperative to effective--and more importantly safe--operation of the machine.

As already stated, always allow the machine to warm up before beginning the stump removal.

You should always look to attack the stump from a downwardly diagonal angle, i.e. angling the machine down, and moving in towards the stump.

For best results, use smooth, side-to-side movements while operating.



# User Guide

## Removing Roots

Cutting smaller roots surrounding the stump before the stump itself can also prove effective.

If the roots are visible, or if you have already used the Stump Grinder on the stump itself, and the roots have become visible, it is recommended you grind these before removing the whole stump.

- 1) Ensure the throttle is set to a high speed.
- 2) Using the brake, swing the Cutting Head wheel to one side and lower smoothly into the roots that surround the stump.
- 3) Raise the Cutter Head wheel sufficiently enough so that the machine can be easily moved. Release the brake and realign the machine.
- 3) Safely move around the stump base until all roots have sufficiently been removed. This weakens the whole stump, which is ready to be removed.

**It is worth noting that if you focus on one area or side of the stump specifically, this may cause a large divot which could result in the machine becoming stuck.**

## Removing the Stump

- 1) Ensure the throttle is set to a high speed.
- 2) Direct the Cutter Head wheel towards the closest corner of the stump to you. Gradually but smoothly swing from side-to-side to remove approx. 1/2 inch of wood with each sweep.
- 3) Raise and lower the Cutter Head wheel in between each swing until satisfactorily removed.

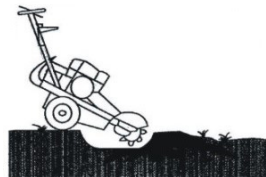
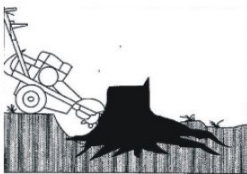

# User Guide

## Turning off the Machine

- 1) To turn off the machine, first ensure that the Cutter Head wheel is not engaged in the stump or roots.
- 2) Use the throttle to slow the Cutter Head wheel.
- 3) Push the (ON/OFF) switch to stop the engine.
- 4) Apply the brake before leaving the controls.

This is the safest way to turn off the machine. In an emergency, you may need to turn the machine off quickly. To do this;

- 1) Immediately push the (ON/OFF) switch to stop the machine.
- 2) Allow all moving parts to come to a complete stop.
- 3) Then apply the brake by pulling the Brake Lever.

**Remember: Under no circumstance should you or another person enter the Danger Zone of this machine, which is located around the Cutter Head wheel, when it is in operation. You should always allow the wheel to come to a complete stop.**

# User Guide

## Maintenance

It is recommended to check all bolts and nuts before and after each use. Tighten where appropriate.

Replace any parts of the machine that are damaged or worn.

Check the oil level after or before each use using the Dipstick. Add more oil if necessary. As a general rule, **oil must be changed after approximately every 68 hours**. It is recommended you keep a track of your usage of the machine.

If the fuel tank has to be drained, this must be done outside.

From time to time, it may be necessary to lubricate the wheel axles and the bearing with grease to enhance the life span and performance of the machine.

If you decide to store your Stump Grinder indoors, do so in a safe environment free from fumes or flammable gases that may alight the fuel within the machine.

The Stump Grinder is a particularly sturdy machine, capable of cutting through most materials. If, however, it hits a solid object in which damage to the machine is caused, it is advised to take it to a specialist for further inspection.

## Transportation

The Stump Grinder is primarily for home use, but has been designed to be transported via a van, trailer, or similar vehicle. It is equipped with Grab Bars which are to be used to lift the machine and strapping it down in-transit. However, bear in mind the machine weighs 110KG. For your own safety, ensure an adequate team of people lift the machine together. You should never attempt to lift it by yourself.

# Troubleshooting

## Resolution Guide

**Please read through the guide below if you have any issues or faults with your machine. The information covers and resolves the majority of frequently asked questions.**

NOTE: As already stated, repairs must be completed by an expert technician or engineer. You should never attempt to repair the machine yourself.

What should I do if...

**Q: ... there are parts missing from my order.**

A: If there appears to be any part missing from your package contact our Customer Support team via the details on the Contact Us page within 7 days of receipt.

**Q. ... my engine won't start.**

A. This could be caused by the position of the Choke. As per the guidelines in 'Starting the Engine', check that the Choke is moved towards a closed position if the engine is cold. If warm, move closer towards open. Once you feel resistance with the Starter Cord, pull firmly and quickly. Also ensure there is petrol and oil in the machine. If you are still struggling to start the engine, try looking online for related videos, or call our helpful Customer Support team. The details can be found in the **Contact Us** page.

**Q. ... my machine won't cut the stump or the roots.**

A. Though the Stump Grinder is a heavy duty tool, removing roots and stumps takes patience and craft. Attacking the roots and surrounding stump first usually provides the best and most efficient result. Remember to check the machine for damage before and after every use. The nature of the process can cause strain on the machine, and it may be necessary to replace the tungsten blades if you feel they are damaged or blunt. If so, see a specialist or contact our Customer Support team for extra parts.

# Troubleshooting

## Resolution Guide

Q: ... my engine is overheating.

A: Turn off your machine completely and clean off all debris in around the blades and motor. Use protective gloves to do this.

Q: ... my engine is not running smoothly.

A: Check to make sure you have moved the choke to the 'open' position after starting. If this does not help, check that your fuel is not contaminated. If so, replace your fuel.

For all other issues please contact our Customer Support department via the details on the Contact page.

# Contact Us

## Sales Department

For information regarding this device or other products from our Monster divisions please use the following details below.

Tel: 01347 878888

Email: [hello@monstershop.co.uk](mailto:hello@monstershop.co.uk)

## Support Department

For queries about this device, warranty, returns or reporting faults please use the following details below.

Tel: 01347 878887

Email: [help@monstershop.co.uk](mailto:help@monstershop.co.uk)

## Website

To view our product range and fantastic offers in the Monster Chef division please visit our website

[www.monstershop.co.uk](http://www.monstershop.co.uk)

## Address

To visit our office Monster House and view our products, send postal correspondence or return items our address is provided below.

Monster House, Alan Farnaby Way, Sheriff Hutton  
Industrial Estate, Sheriff Hutton, York YO60 6PG



---

Monster Group (UK) is one of the UK's fastest growing online retailers. We supply a diverse range of products which offer exceptional value for money. We strive to provide the best possible customer experience with free UK delivery across all our products and a Monster Guarantee for 100% satisfaction.

Our dedicated customer service team will be more than happy to help with any questions you may have.

Home & Garden  
Storage Shelving  
Sign & Digital  
Retail & Hospitality  
Commercial Equipment

**Check out all our Monster brands at [www.monstershop.co.uk](http://www.monstershop.co.uk)**

---