



TOUCH SCREEN JUKEBOX

26051

INSTRUCTION MANUAL

www.monstershop.co.uk



SPECIFICATION

PRODUCT DESCRIPTION

Everyone loves listening to their favourite tunes, whether it's relaxing with friends or getting the party started - so get rid of that dusty old hi-fi system and introduce a retro music jukebox with everything from a CD player to Bluetooth connectivity.

As a free standing stereo system, you can give this CD jukebox centre stage and it will create an eye-catching, nostalgic feature.

It might look like a vintage model with the polished wooden cabinet but beneath the 1950's style chrome trim, bright lights and speaker grill stands a powerful modern sound that runs on 21st century technology with a built in touch screen.

PRODUCT SPECIFICS

FREQUENCY RANGE:	FM 87.5--108 MHZ
INPUT:	100-240VAC - 50/60 Hz
OUTPUT:	13A- / 5A+
POWER CONSUMPTIONS:	65W
DIMENSION	(W*H*D): 57 x 105 x 30 cm
WEIGHT:	19.5Kg approx.
POWER AMPLIFIER OUTPUT CHANNEL:	2.0 sound channel
POWER SOURCE:	Refer to rating label on back plate

ITEM CONTENTS

- 1 x Touch Screen Jukebox
- 1 x Remote (CR2025 Battery Included)
- 1 x RCA Cable

SPECIFICATION

PRODUCT FEATURES

- A. Line Out
- B. Touch screen
- C. Video file usb flash drive socket
- D. The main key operation panel
- E. Color changing LED light source
- F. Speaker

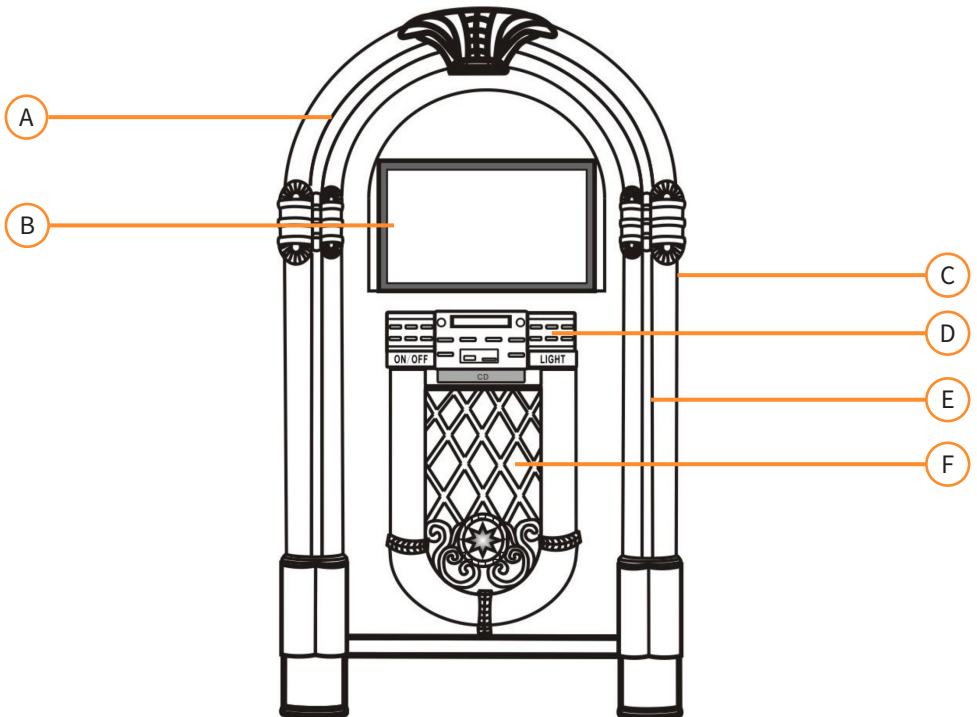

Monster Group UK Limited's liability will be limited to the commercial value of the product only.

SPECIFICATION

MAIN KEY OPERATIONAL PANEL

1. Display
2. VOL+(volume)
3. ►►(NEXT/Fast forward)
4. ►|| (PLAY/PAUSE)
5. VOL-(volume)
6. ◀◀PREV/F.R
7. ■ (STOP)
8. EQ (Voice patterns)
9. ON/OFF (Standby)
10. MODE (Function)
11. Power switch (ON/OFF)
12. USB port
13. CD DOOR
14. REM:Remote receiver
15. F+10 (forwards 10 tracks)
16. Stereo/Mono
17. PR+ (Folder+)
18. F-10 (back 10 previous tracks)
19. AUTO (Automatic search radio program)
20. PR- (Folder-)
21. REP (Repeats)
22. PROGRAM
23. CD DOOR OPEN OR CLOSE/Memory
24. LIGHT switch
25. SD/card input

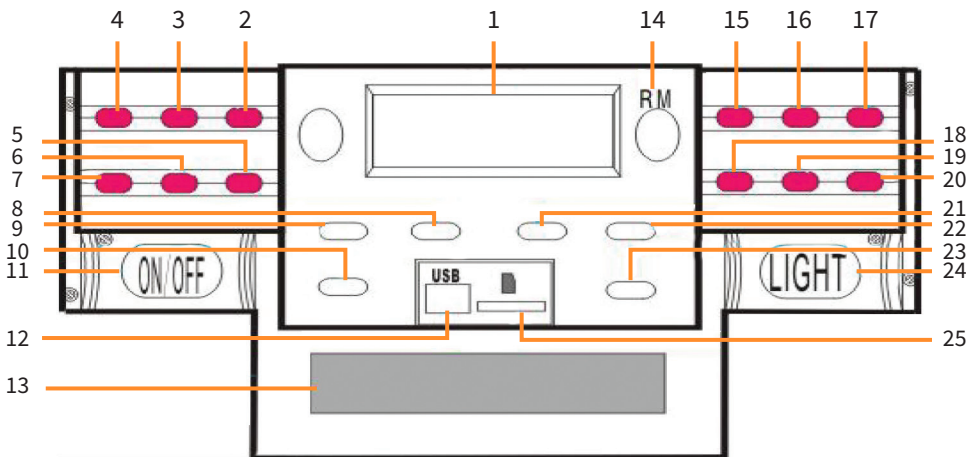

SAFETY ADVICE

SAFE WORKING PRACTICE

Please read through the Safe Working Practice to ensure prevention of injury or damage to the device.

Do not use this product for anything other than its intended purposes.

Ensure you have read and fully understood the instruction manual and safety advice before using this product.

Retain instructions - The safety and operating instructions should be retained for future reference.

Heed Warnings - All warnings on the appliance and in the operating instructions should be adhered to.

Follow instructions - All operation and use instructions should be followed.

Water and Moisture - The appliance should not be used near water; for example, near a bathtub, wash bowl, kitchen sink, laundry tub, in a wet basement, or near a swimming pool etc.

The appliance should always be used or stored on a flat stable surface indoors.

Ventilation - The appliance should be situated so that its location or position does not interfere with its proper ventilation. For example, the appliance should not be situated on a bed, sofa, rug, or similar surface that may block the ventilation openings; or placed in a built-in installation, such as a bookcase or cabinet that may impede the flow of air through the ventilation openings.

Heat - The appliance should be situated away from heat sources such as radiators, heat registers, stoves or other appliances (including amplifiers) that produce heat.

WARNING: Keep batteries out of reach of children. Swallowing may lead to serious injury or death in as little as 2 hours due to internal burns. If swallowed, go straight to a hospital emergency room. Dispose of used batteries immediately.

SAFETY ADVICE

SAFE WORKING PRACTICE

Power Sources - 220-240 V 60Hz. Power-Cord Protection Power supply cords should be routed so that they are not likely to be walked on or pinched by items placed upon or against them.

Power cords should be regularly inspected and if any damage is discernible then stop using and consult a qualified electrical technician.

This item is fitted with a 3 amp fuse only.

Cleaning – Unplug this product from the wall electric socket before cleaning. Do not use liquid cleaners or aerosol cleaners. Use a damp cloth for cleaning.

Non use Periods - The power cord of the appliance should be unplugged from the outlet when left unused for a long period of time.

Object and Liquid Entry - Care should be taken so that objects do not fall and liquids are not spilled into the enclosure through openings. Switch off immediately at power source if the item comes into contact with liquids and refer to a qualified electrical technician.

Refer to a suitable qualified technician if the appliance is damaged, needs servicing or has been dropped.

Servicing - The user should not attempt to service the appliance beyond general cleaning and changing of stylus.

This appliance/product is not intended for use by persons (including children) with reduced physical, sensory or mental capabilities, or lack of experience and knowledge, unless they have been given supervision or instruction concerning the use of the appliance by a person responsible for their safety. Children should be supervised so that they do not play with the appliance.

NOTE:

1. If you operate the device in a hurry, which may cause a failure, you need to restart the device.
2. If you don't already know how to operate the device, you'll need to learn more about tablets.
3. Do not let children tap or scratch the display screen with sharp objects, this makes the device less responsive to use, or not available.

OPERATION GUIDE

MICROPHONE SOCKET AND OPERATION

1. USB port for media player.
2. Adjust the reverb of the microphone.
3. Adjust the volume of the microphone.
4. The cable jack of the microphone.

- If you wish to use files stored on a USB memory stick plug the memory stick into the USB port.
- There are matching microphones available on the market.
- You can sing along with the music of the product or sing alone.

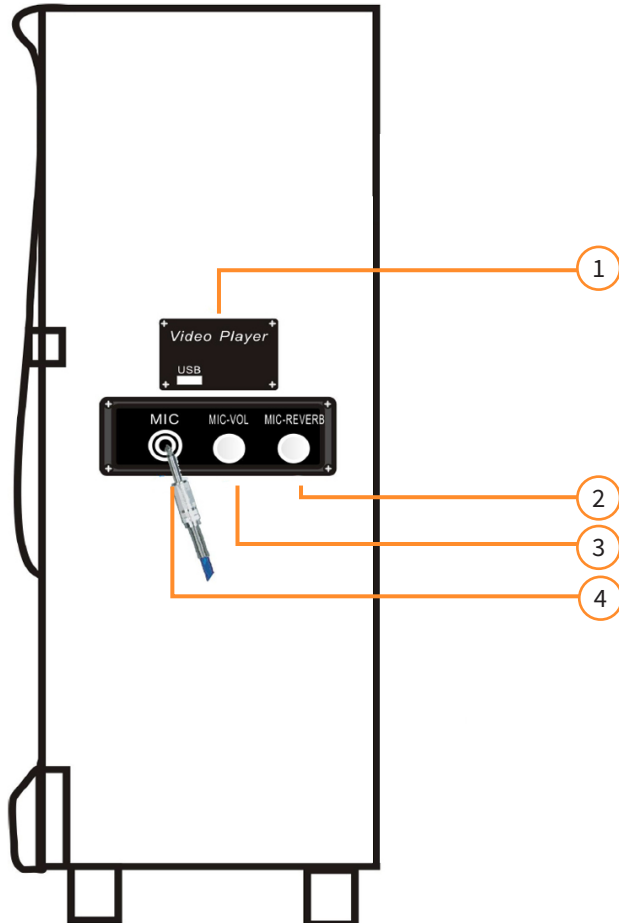

OPERATION GUIDE

PRODUCT REAR PANEL FUNCTION LAYOUT

Connect the power adapter to the back of the product (insert into the power socket).

1. Light Mode (Color Flash)
2. FM Antenna
3. Power adapter
4. DC power socket

NOTE: The FM antenna may need to be repositioned to receive the best signal on your chosen Radio station, please also ensure the antenna wire is fully unwound. Unplug the power adapter when the product is not in use, put away the power adapter.

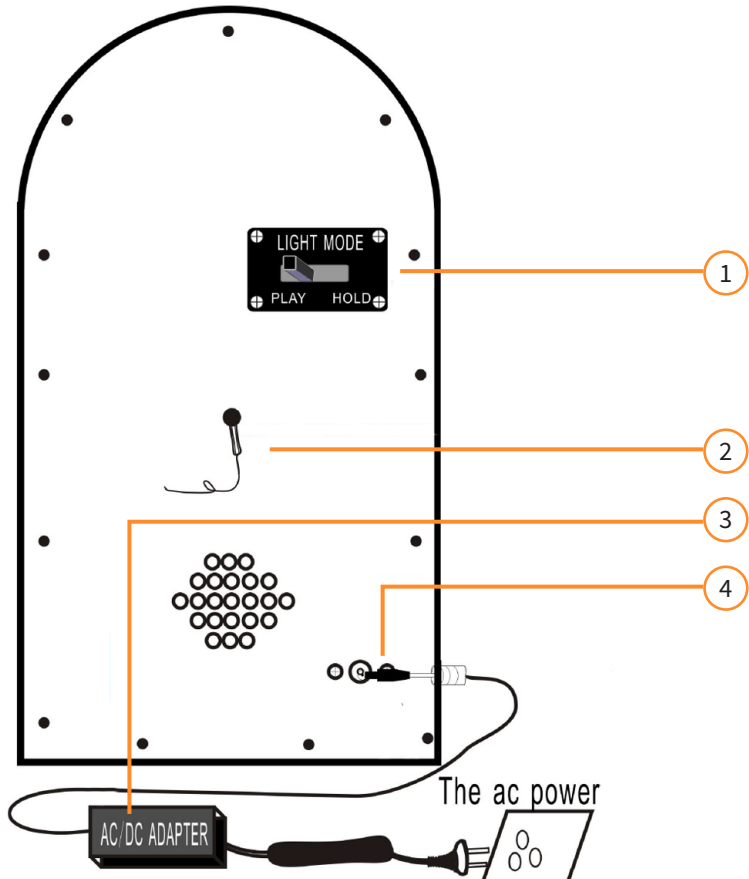

OPERATION GUIDE

SETTING THE CORRECT TIME

American version:

When the jukebox enters standby mode the LCD display panel will illuminate and the time "12:00" will appear on the LCD display panel.

European version:

When the Jukebox enters standby mode the LCD display panel will illuminate and display the time "00:00".

For example, the American version of the operation:

To set the time, simply press the "PROG" button on the control panel or remote control (No. 22 on the Control panel diagram or No. 6 on the remote control diagram) and hold this button down for 3-5 seconds, until "12-H" is displayed on the screen ("12-H" indicates that the time will be set in 12 hour format).

Then, press "NEXT" or "PREV" can choose 12 or 24 hour format; Once "12-H" is displayed on the screen press the "PROG" button again. The display will revert to "00:00" on the display, however, with the "12" flashing. Use the "NEXT" and/or "PREV" buttons on the control panel or the "PREV/F.R" and/or "NEXT/F.F" buttons on the remote control (No. 5 and 16 on the control panel diagram or remote control diagram), to select the correct hour (keep in mind it will be set in 12 hour time), then press the "PROG" button to confirm. The second "00" will now be flashing. Use the "NEXT" and/or "BACK" buttons or the "PREV/F.R" and/or "NEXT/F.F" buttons to select the correct minutes, then press the "PROG" button to lock this figure in.

NOTE: The time will only be saved in The Jukebox The when it is working or standby mode. If you wish to save the set time into your Jukebox, do not press the POWER button (No. 11 on the control panel diagram) to turn the unit off, simply press the ON/OFF button (No. 9 on the control panel diagram) to set the Jukebox to standby. If the POWER button (No. 11 on the control panel diagram) is used to turn the Jukebox off, it will erase the time setting and the above process will need to be repeated in order to reset the correct time the next time it is turned on.

USING THE FUNCTIONS

RADIO OPERATION

Radio operation (Radio FM accepts frequency range: 87.5-108MHz)

1. This Jukebox features an inbuilt FM Tuner with auto-search function and a 20 station programmable memory.
2. When using for the first time, press the POWER button and the Jukebox will switch to standby mode. Press the ON/OFF button on the control panel or the POWER button on the remote control to turn the Jukebox ON. The Jukebox should start in FM radio mode, the LCD display will show FM 87.5MHz and the speakers will emit a fuzzy sound (unless the frequency 87.5MHz contains a radio station in your area). If it does not automatically start in FM radio mode, press the MODE button on the Jukebox or the FUNCTION button on the remote control until FM radio mode is entered.

Option 1 - Auto Search and Save. Press the AUTO button to perform an auto-search from 87.5MHz upwards. The first 20 stations found will be stored in memory (labelled as P01 to P20). Press the PR- or PR+ buttons to navigate through all preset stations.

Option 2 - Auto Search Only: Press and hold the ◀◀ or ▶▶ button to search up or down the FM frequency to find a station with strong reception. This auto-search function will NOT save the stations found automatically and it will NOT continue to search past the first radio station found. Press (do not hold) the ◀ or ▶ button repeatedly. The FM tuner will search up or down the FM band by 0.05Mhz increments for each press.

Manual save station: Press ◀◀ or ▶▶ button, find your favourite radio show, press “MEM” button to display” P01”, Press “PR-” and “PR+” again within 3 seconds to select the storage location. Press the”MEM”button again in 3seconds to save. Up to 20 radio programs can be stored.

Connecting to the Jukebox from your mobile device for the first time:

1. Turn on the Jukebox and will switch to standby mode.
2. Press the ON/OFF button on the control panel or the POWER button on the remote control to turn the Jukebox ON.
3. The Jukebox should start in FM radio mode, the LCD display will show FM 87.5MHz and the speakers will emit a fuzzy sound (unless the frequency 87.5MHz contains a radio station in your area). If it does not automatically start in FM radio mode, press the MODE button on the Jukebox or the FUNCTION button on the remote control until FM radio mode is entered.

Note: The American version of “FM” frequency, forward or backward, jumped 0.1 MHz;The European version of the “FM frequency, forward or backward, jumped 0.05 MHz; FM antenna, it needs long, put in the radio effect is the best location. (FM antenna In the back of the product).

Note: When programming to store radio stations, local radio programs must have a strong signal of 20 stations or more in order to store to 20 stations. Otherwise, only the number of stations that can be received can be stored.

USING THE FUNCTIONS

CD OPERATION

CD operation (CD should be placed on the tray with the label side up)

- A. Press “MODE” button until led display indicate “- - - -”, then display will show number of songs and then begin to start playback.
- B. Press the (Open/Close) button on the control panel, or the EJECT button on the remote control to open the CD tray
- C. Load the CD on the CD tray, with the label facing up and the shiny side facing down.
- D. Press the (Open/Close) button on the control panel, or the EJECT button on the remote control again to close the CD tray.
- E. Press “Next/F.F” to select your desire song.
- F. Press “REP” once to repeat one song, the REP indication at the top left corner on the led display will flash. Press “REP” one more time to repeat all songs in the track and the REP indication at the top left corner on the led display will appear. Press “REP” again to cancel repeat function.
- G. To play songs randomly, press “REP” button until the led display “RAN” on the bottom of the display.
- H. For programming, press “STOP” button to stop playback. The remote control Press “PROG” to enter programming mode. The led display will flash and indicate “P 01”, select the song that you want to program and then press “PROG” again. Press “Play/Pause” to stop programming and start to playback the programmed songs. This unit can program up to 20 songs (Further info on this function on page 12).
- I. increase the voice, Turn the volume knob clockwise “UP” until you reach the desired volume level.
- J. reduce voice, Turn the volume knob counter clockwise “DOWN”, until you reach the desired volume level.

USB/SD operation.

- A. Press “Mode” button until led display indicate “ USB - - - -”, then display will show number of folder, then number of songs and start playback.
- B. Press “Next or Prev” or “F+10/-10” to select your desire song.
- C. Press “REP” once to repeat one song, the REP indication at the top left corner on the led display will flash. Press the “REP” display “REP FOLDER” repeat album; Press “REP” one more time to repeat all songs in the track and the REP indication at the top left corner on the led display will appear. Press “REP” again to cancel repeat function.
- D. To play songs randomly, press “REP” button until the led display “RAN” on the bottom of the display.
- E. For programming, press “STOP” button to stop playback.

USING THE FUNCTIONS

PAIRING WITH BLUETOOTH

To begin pairing with a Bluetooth device.

- 1) Press “MODE” button until LCD display “BLUE” and wait for 3 seconds to make the Jukebox speaker discoverable.
- 2) Turn on the Bluetooth device and let it automatically search for available Bluetooth devices.
- 3) From the Bluetooth device list, select the device named “JUKEBOX”.
- 4) Once the pairing is completed, the Bluetooth will indicated “connected”.

To start playback songs from your Bluetooth device. You can control from your Bluetooth device or from the Jukebox itself or remote control (provided).

- A. Control from the Bluetooth device. Use keys on the display to select songs, volume +“UP”/-“DOWN”, play/pause and next/prev function.
- B. Control from the Jukebox/remote control.
- C. Once pairing is completed, the song from the Bluetooth device automatically start to playback.
- D. Press “VOL+/-” to control the sound level.
- E. Press “Next or PREV” to select next and previous song respectively.
- F. Press “PLAY/PAUSE” to pause or continue playback.
- G. To end the pairing, press “MODE” button to other functions or turn off the Bluetooth connection from the Bluetooth device.

Tips for Operating Bluetooth® Connection:

1. When pairing the Jukebox with your Bluetooth® enabled device, please place the Bluetooth® enabled device as close as possible to the Jukebox.
2. The Bluetooth® connection may not work well due to the below:
 - There is an obstacle between the Jukebox and the Bluetooth® enabled device.
 - There is a device using the same Bluetooth® frequency as the Jukebox such as medical equipment, microwave ovens or wireless LAN devices.
 - Pairing is limited to one Bluetooth® enable device. Multi-pairing is not supported.

Note: When connecting another mobile device to the Jukebox, make sure no other mobile devices are connected to the Jukebox.

REMOTE CONTROL DIAGRAM:

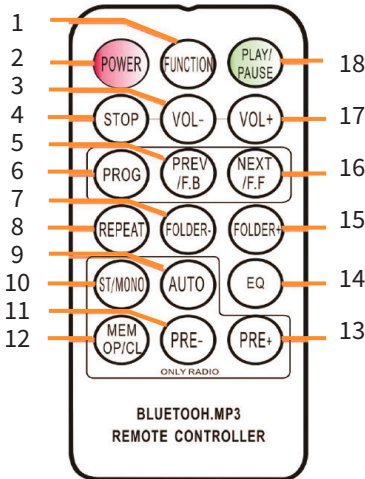

USING THE FUNCTIONS PROGRAM

- A. While playing back from a music source, press the stop button.
- B. Press the program button to enter the program mode. The word PROG will flash in the bottom left corner of the display screen. A position number will also be flashing on the screen (eg: p01).
- C. Press the next or back buttons to select which track you want to program into position. When you have made your selection, press the program button to save it.
- D. You can then repeat the same steps to fill in more positions.
- E. When done, press play to begin your music playback. You can do this at any stage once you have programmed the amount of tracks you want.
- F. At any stage during the program process you can press stop to cancel.
- G. 'FUL' will display on the LCD screen when the Max amount of memory location have had been filled.

FUNCTIONS ON THE REMOTE CONTROL:

1. Function: To select between the different functions such as the FM tuner, CD player, USB input, SD input, Bluetooth and MP5 (Media player).
2. Power: the POWER button on the remote control diagram to exit standby mode and enter FM Radio Mode.
3. VOL-: reduce voice, press the button repeatedly or press once and hold down until you reach the desired volume level.
4. Stop: press to stop a track.
5. PREV/F.B: fast back: press to go to the previous track or rewind back through a track. You can then press the play button to start playback.
6. Program: Allows you to program only particular songs of your choice to playback from your music source. (Further info on this function on page 12).
7. Folder-: press to skip to the first track in the previous folder. If the Jukebox is in random ("RAN") mode the folder skipping function will be disabled.
8. Repeat: press to replay one particular song, press the button once repeating ONE song only, press the button twice repeating ALL the songs, press the button three times repeated RANDOM play.
9. Auto: press to Radio Auto-search and save stations
10. ST/Mono: Stereo/Mono Selection in Radio (where available).
11. PRE-: To playback previous stored radio station.
12. MEM/OP/CL: tune the radio to the desired station The Jukebox has a 20 station memory to store the user's favourite radio stations. Note: when programming to store radio stations, local radio programs must have a strong signal of 20 stations or more in order to store to 20 stations. Otherwise, only the number of stations that can be received can be stored. OP/CL (EJECT): When you play the CD, Press "OP/CL" button on the remote control Again to close the CD tray or open the CD tray.
13. PRE+: To playback a next stored radio station.
14. EQ: To change the Equalizer setting equalizer settings preloaded on to the Jukebox are Flach (FLA), Classical (CLA), Rock (ROC), Pop (POP), and Jazz (JAZ).

USING THE FUNCTIONS

PROGRAM

15. Folder+: press to skip to the first track in the next folder. If the Jukebox is in random (“RAN”) mode the folder skipping function will be disabled.
16. NEXT/F.F: fast forward, press to go to the next track or fast forward through a track. You can then press the playback button to start playback.
17. VOL+: increase the voice, press the button repeatedly or press once and hold down until you reach the desired volume level.
18. Play/pause : press to play or pause a track.

TURNING ON THE LIGHTING EFFECTS:

The Jukebox features 2 see colour changing LED light tubes that are using The LED CONTROLLER. There are also several other multicoloured LED lighting effects that are featured in The CD player and USB/SD compartment and The at The bottom of The speaker panel. To turn on the LED lighting effects simple press the LIGHT button on the control panel (number 24) from the graph on page 5. All the LED lighting effects will illuminate.

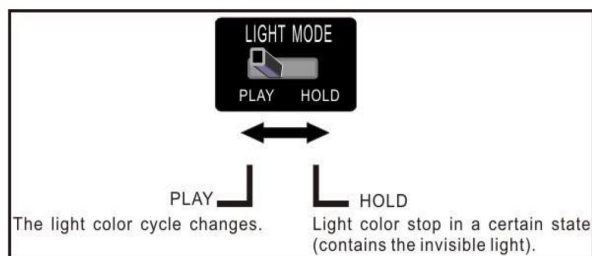

NOTE: The lighting effects operate independently of the POWER button (No. 24 on the control panel diagram). The LIGHT button controls the power to The lighting effects on the back of The machine.

On the rear of the Jukebox, there is an LED Light Mode Switch (Number 4 On the Jukebox with parts diagram item 3) the Colour Changing LED Light Tubes will fade in and out of several different colours continuously.

When set to HOLD mode the LED Light Tubes will be illuminated in only one colour. By switching to PLAY mode, the LED Light Tube will begin to cycle through the colours. By switching back to HOLD, different colours can be selected to display and hold (please note that these colours have been predetermined and may not be the exact same colours the light tube was illuminated when switched to “HOLD” mode).

To turn OFF the lighting effects all together simply press the “LIGHT” button once again, and all lighting effects will no longer be illuminated. Note: in the “hold” mode, there may be no visible light, is normal (need to adjust the switch).

USING THE FUNCTIONS

MEDIA PLAYER - TOUCH SCREEN

FUNCTION INTRODUCTION

1. Display size - 12 inches.
2. USB 2.0 interface.
3. Video resolution - 1080P (1920×1080).
4. Operating system: Android 6.0.1.
5. The playback mode supports various playback modes such as loop, timing and insert.
6. Network support Ethernet, support WiFi, wireless peripheral extension.
7. Video supports WMV, avi, FLV, rm, RMVB, mpeg, ts, h.265, mp4.
8. Image formats support BMP, JPEG, PNG, GIF, etc;RSS current events, Flash animation, dynamic web pages.
9. Supports office documents: the system supports playing PPT, WORD, EXCEL and PDF documents.
10. Supports web page and can scroll form web page, achieve large page zoom display.
11. Single player playback: support single player playback of imported programs on USB disk.
12. Log management: powerful logging function, and can get every instruction pointing to the state.
13. Any split screen: making programs can stretch,drag and drop material area size arbitrarily, with digital calendar clock module, weather forecast module, program template library, support self-designed template: provide thumbnail function.

USE MEDIA PLAYER

Press “MODE” button until led display indicate “nP5”, Wait about 5 seconds equipment start up completed.

USING THE FUNCTIONS

BOOT INTERFACE AND OPERATION

Choose the right language for you:

1 Click: “☰”

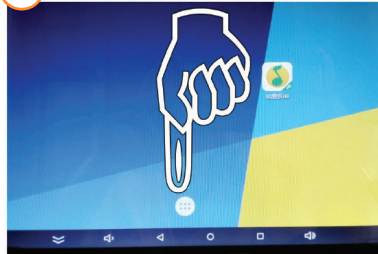

2 Click: Settings



3 Click: “🌐”

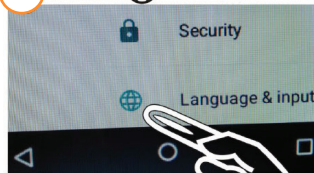

Select the language & input

4

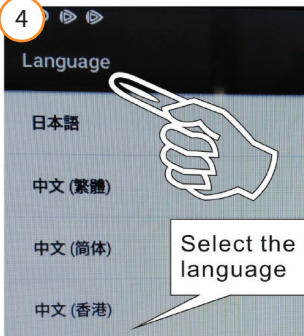

USING THE FUNCTIONS

WIRELESS AND NETWORKS

CLICK WIFI: 

- A. In the “Settings” interface, connect to the wireless network through “WIFI”, you can also set up other projects to suit your needs.
- B. After successful network connection, you can surf the Internet.
- C. Read USB disk files through the “USB” socket on the side of the machine.



- D. Can play music, video files, browse pictures.

TROUBLESHOOTING

RESOLUTION GUIDE

WHAT DO I DO IF THERE ARE MISSING PARTS FROM MY ORDER?

If there appears to be any part missing from your order, contact our friendly and helpful Customer Support Team within 7 days of receipt.

The power cord must be connected firmly.

THERE IS NO RADIO RECEPTION:

The MODE selector has not been set to the correct position. Press the and buttons to find a radio station. Switch the AUX IN jack to “OFF”. Press “VOL+” to turn up the volume.

THE DISC DOES NOT PLAY OR THE SOUND SKIPS:

Clean the disc and reload with the label facing up.
Change the installation location. Press the ON/OFF button.
Press the STOP button and then program the tracks.

PROGRAMMED DISC PLAY WILL NOT FUNCTION:

The AC power cord is not connected to an AC wall outlet. Check that the power cord is connected firmly. Push the power button from the “OFF” position to the “ON” position.

NO SOUND OUTPUT:

Press the “ON/OFF” button. Press “VOL+” to turn up the volume.

SEVERE HUM OR NOISE:

The TV or VCR is too close to the stereo system. Separate from the TV or VCR.

DISPLAY GARBLED, NON-FUNCTIONAL

Turn off the power to re-start.

**FOR ALL OTHER ISSUES, PLEASE CONTACT OUR
CUSTOMER SUPPORT TEAM.**

Monster Group (UK) is one of the UK's fastest growing online retailers. We supply a diverse range of products which offer exceptional value for money. We strive to provide the best possible customer experience with free UK delivery across all our products and a Monster Guarantee for 100% satisfaction.

For information regarding this device or other products from our Monster divisions please contact Sales.

SALES

TEL: 01347 878 888
EMAIL: hello@monstershop.co.uk

For queries about this device, warranty, returns or reporting faults please contact Support.

SUPPORT

TEL: 01347 878 887
EMAIL: help@monstershop.co.uk

Pour plus d'informations concernant cet appareil ou d'autres produits de nos divisions de Monster veuillez utiliser les détails suivants ci-dessous.

DÉPARTEMENT COMMERCIAL

TEL: 01347 878 888
EMAIL: bonjour@monstershop.eu

Pour les interrogations concernant cet appareil, la garantie, les retours ou les défauts de déclaration veuillez utiliser les détails suivants ci-dessous.

DÉPARTEMENT DE SOUTIEN

TEL: 01347 878 887
EMAIL: help@monstershop.co.uk

Para información sobre este dispositivo u otros productos de nuestras divisiones de Monster por favor use los siguientes detalles.

DEPARTAMENTO DE VENTAS

TEL: 01347 878 888
EMAIL: hola@monstershop.eu

Para consultas sobre este dispositivo, la garantía, devoluciones o denuncias de fallos por favor use los siguientes detalles.

DEPARTAMENTO DE SOPORTE

TEL: 01347 878 887
EMAIL: help@monstershop.co.uk

Für Informationen bezüglich dieses Geräts oder anderer Produkte aus unserer Monster-Abteilung, benutzen sie die folgenden unten aufgeführten Angaben.

VERKAUFABTEILUNG

TEL: 01347 878 888
EMAIL: hallo@monstershop.eu

Für Fragen über dieses Gerät, die Garantie, Rückgaben oder bei Störungen, benutzen sie die folgenden unten aufgeführten Angaben.

SUPPORT-ABTEILUNG

TEL: 01347 878 887
EMAIL: help@monstershop.co.uk

Per informazioni riguardanti questo dispositivo o altri prodotti dalle categorie Monster utilizzare i dettagli sotto riportati.

DIPARTIMENTO VENDITE

TEL: 01347 878 888
EMAIL: ciao@monstershop.eu

Per domande riguardo dispositivo, garanzia, reso o per riferire di guasti, utilizzare i dettagli sotto riportati.

DIPARTIMENTO SUPPORTO

TEL: 01347 878 887
EMAIL: help@monstershop.co.uk

Monster House, Alan Farnaby Way,
Sheriff Hutton Industrial Estate,
Sheriff Hutton, York, YO60 6PG
www.monstershop.co.uk



 Try **Monster**. Buy **Monster**. Be **Monster**. 