

A StepAlong by Monster Shop (UK)

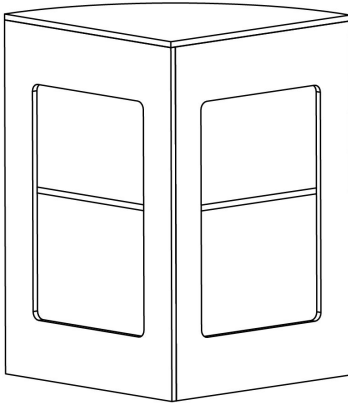

## CM60 Shop Counter

214585, 214586, 214587

### Unit Overview

The curved corner shop counter works just as well as a standalone unit as it does as part of a team as an extension to other counters. To properly round off its appeal, it also has an expensive-looking laminate finish. Why not try it as a point of sale shop counter or alongside other counters to make a customer service area? Let customers be almost as impressed with its design appeal as they are with your stock. You can also secretly store handy items on its shelves that you need access to in a hurry, like till roll or carrier bags. Whether you decide to use this corner shop counter as the point of sale or as a beautiful retail display unit, it will give your stock and establishment that little extra touch of class and professionalism. Available in maple or white lilac.

### Dimensions

**Width:** 600mm

**Height:** 900mm

**Depth:** 600mm



## Safety Advice

- Make sure the unit is positioned on a flat, stable surface to prevent wobbling or tipping.
- If placing the unit on uneven flooring, use appropriate levelling methods to secure the unit.
- Do not exceed the specified weight limits for the shelves and surfaces to avoid damage to the unit or risk of injury.
- Ensure products are evenly distributed across shelves to prevent tipping or overloading.
- Ensure that children do not climb or play on the unit to prevent accidents or injury.
- Regularly inspect for any wear, such as loose screws or weak joints, and tighten or repair as necessary.
- Be cautious when handling items on glass shelves. Do not overload the shelves beyond their stated capacity, as this could lead to cracking or shattering.
- There may be debris and/or sawdust in the pre-drilled holes. Remove this before commencing with assembly. Use gloves to remove it.

## Parts

Part 1 - Counter Top

1 Piece(s)



Part 3 - Bottom Shelf

1 Piece(s)



Part 5 - Side Panel

1 Piece(s)



Part 7 - Base

1 Piece(s)



Part B - CAM Lock

15 Piece(s)

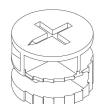

Part 2 - Middle Shelf

1 Piece(s)



Part 4 - Side Panel

1 Piece(s)



Part 6 - Back Panel

1 Piece(s)



Part A - Screw

15 Piece(s)



## Steps (11)

1.

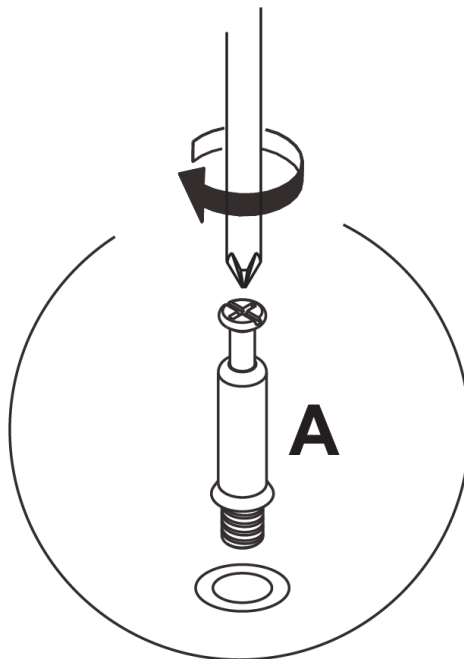
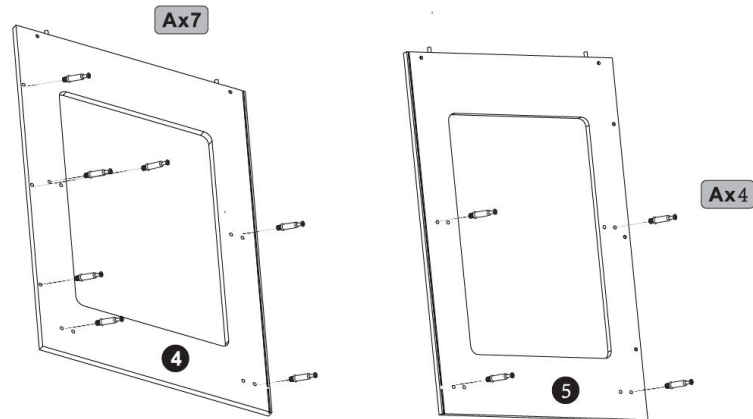

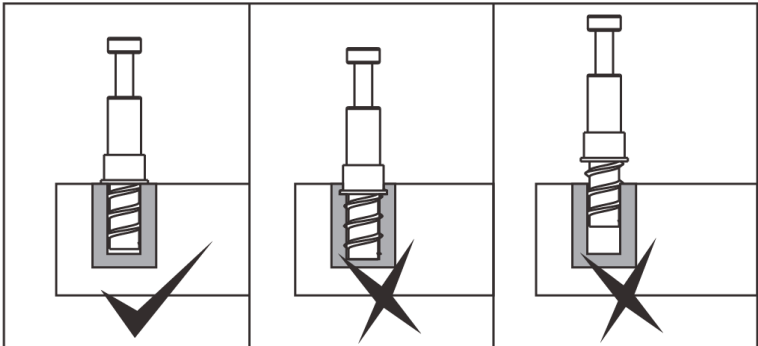

2.

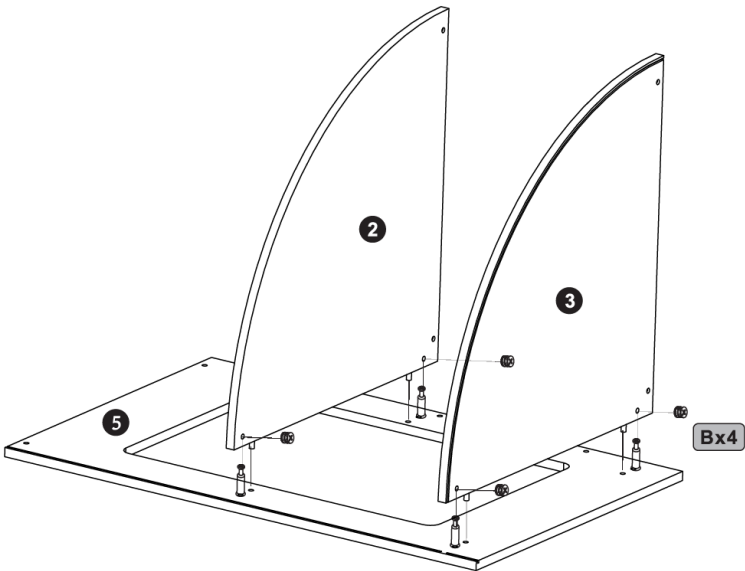

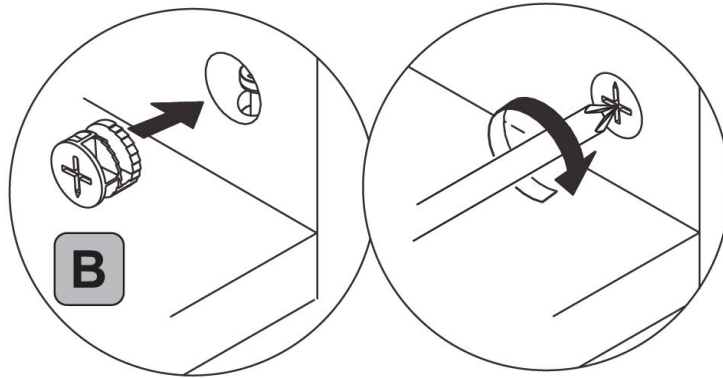

3.

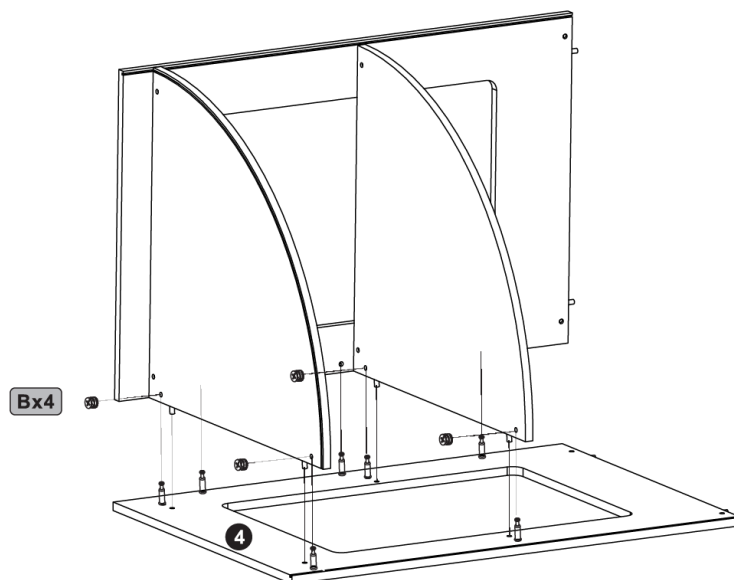

4.

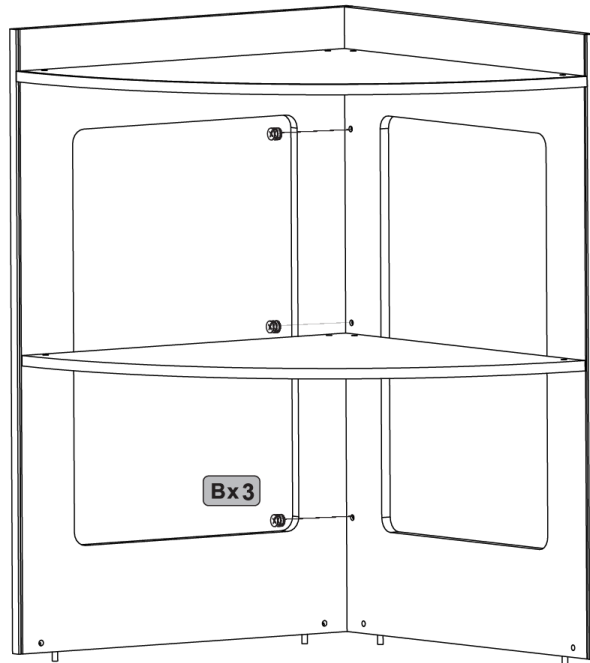

5.

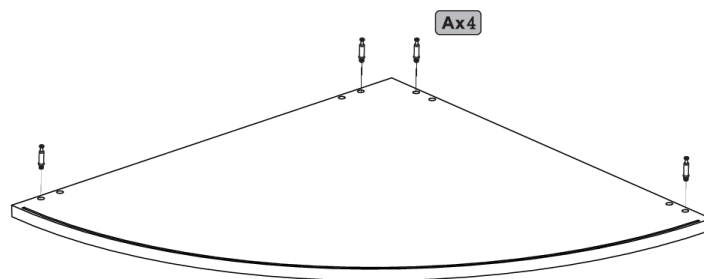

6.

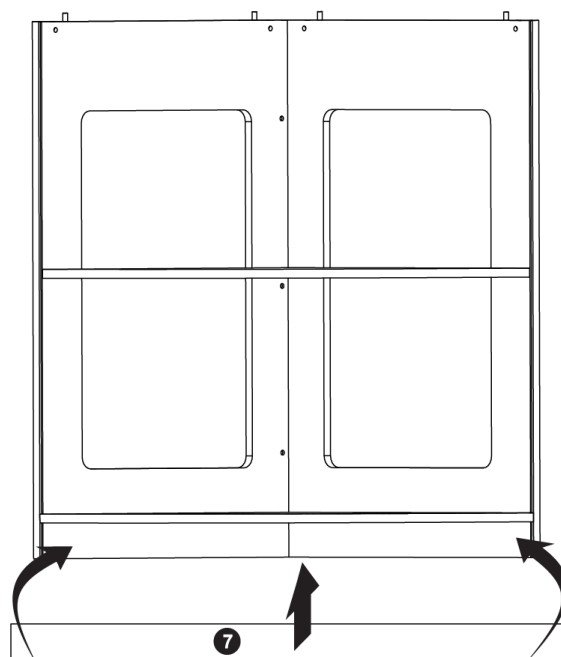

7.

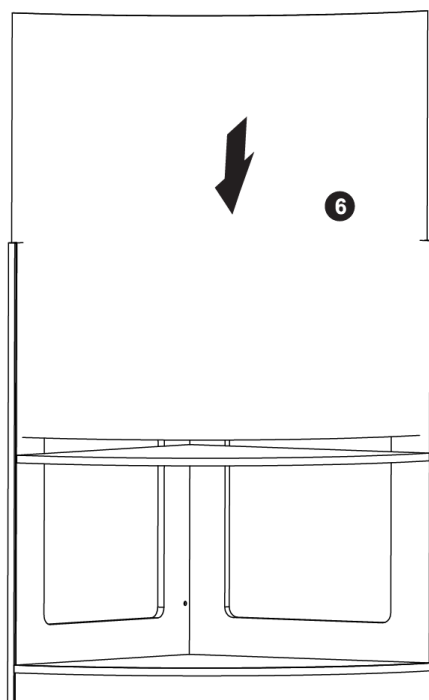

8.

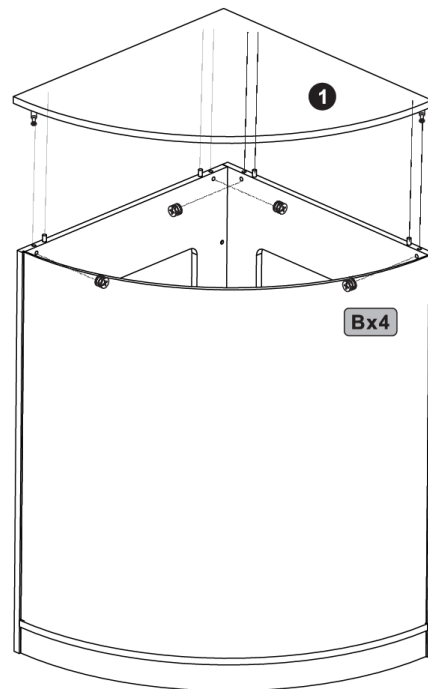

9.

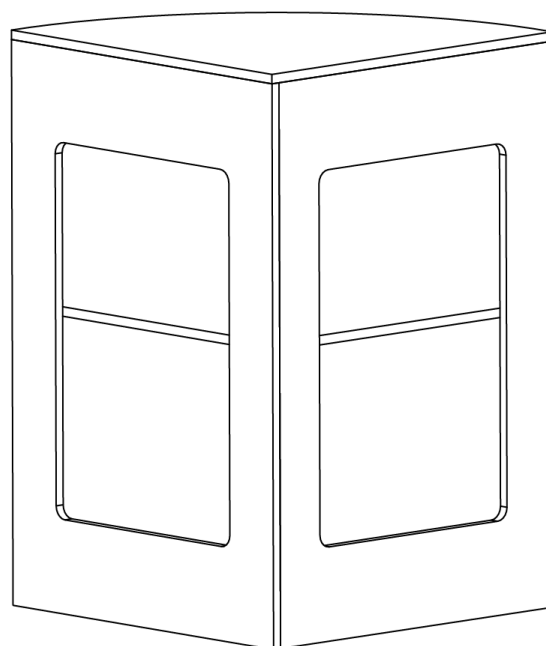



## 10. Maintenance

- Clean the unit with a soft, damp cloth. Avoid using harsh chemicals or abrasive cleaners, which could damage the laminate or glass surfaces.

## 11. Troubleshooting

### • **WHAT DO I DO IF THERE ARE MISSING PARTS FROM MY ORDER?**

If there appears to be any part missing from your order, contact our friendly and helpful Customer Support Team within 7 days of receipt.

- **FOR ALL OTHER ISSUES, PLEASE CONTACT OUR CUSTOMER SUPPORT TEAM.**

