

# Pull Out Tap Installation

These instructions are for fitting your pull out tap i.e. Padstow or Rainbow.

The following items should be included with the tap:

- 1) Hot and cold connectors
- 2) Flexi pipes
- 3) Hose connector
- 4) Pull out hose
- 5) Weight
- 6) Rubber seal

Both the weight and rubber seal are packed in a separate small box.

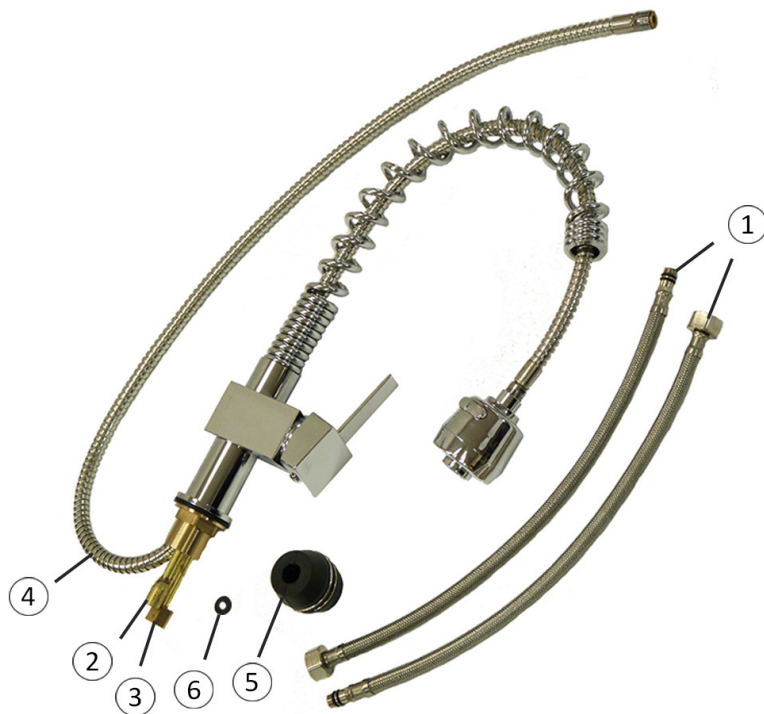

1) Turn off the water supply before installing this tap.

2) Attach the thin ends of hot and cold connectors to each of the flexi pipes.

3) Push the rubber seal inside the hose connector

4) Then screw the end of the pull out hose into the hose connector.

5) The weight now needs to be attached to the pull out hose, this will help it push back into the tap easier. On the weight there are two clips, remove these two clips to split the weight in two halves. Place the two halves around the hose and replace the clips to secure the weight.

The bottom of the pull out hose forms a U shape, the weight needs to be attached to the side of the U that feeds up into the tap, as shown:

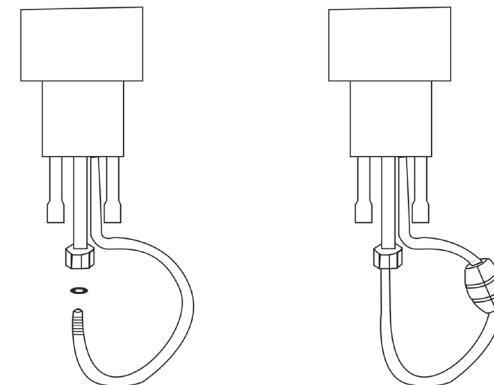

6) The tap is now ready to be installed. The nut ends of the hot and cold connectors can be attached to the isolator valves in your sinks assembly.

If you find you are having any issues with your item please contact our Customer Support team who will be happy to help.

Phone: 01347 878887

Email: [support@monstergroupuk.co.uk](mailto:support@monstergroupuk.co.uk)